

# Solid timber joist separating floor

CELLECTA ScreedBoard® 28 laid on timber sub-floor  
Use with timber frame walls only

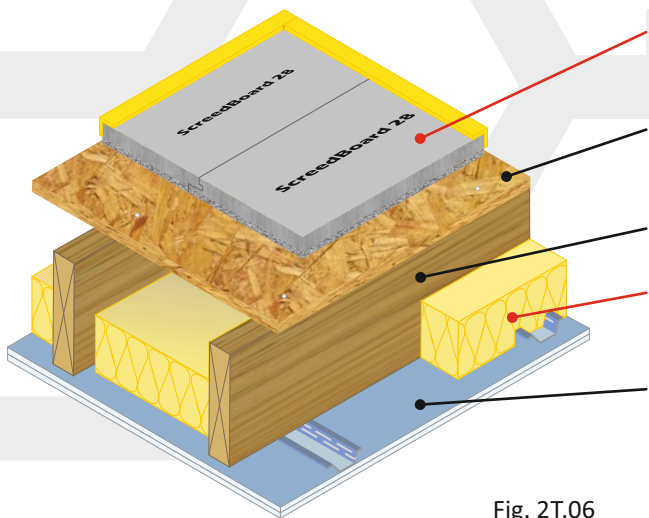

Fig. 2T.06

- Floating floor treatment**  
CELLECTA ScreedBoard® 28  
(See Table 2T.06a for full details)
- Floor decking**  
15mm (min) thick wood based board, density 600kg/m³ (min)
- Joists**  
220mm (min) solid timber joists
- Absorbing material**  
  - 50mm CELLECTA FIBREfon® Micro 50
  - 100mm (min) quilt insulation (10-36kg/m³)
- Ceiling**  
See Table 2T.06b for ceiling treatment options



Table 2T.06a

### Installation Details

#### Resilient overlay platform floor system

**1** ScreedBoard® 28

Ultra high performance, dense acoustic composite overlay board

28mm x 600mm x 1200mm

Weight: 26kg/m² / 18.72kg/board

**A** CELLECTA Pro Adhesive

ScreedBoard joint adhesive

Bottle size: 1L / 33m² coverage

**2** YELOfon® FS50

Preformed flanking strip:

6mm x 50mm x 30mm x 2m

**Additional items required:**

- CELLECTA ScreedBoard fixing tools
- Sound absorbing quilt laid between joists:
- 50mm CELLECTA FIBREfon Micro 50 non-itch polyester wool
- 100mm (min) Mineral wool 10-33kg/m³

**Construction notes**

Materials must be installed in accordance with manufacturers' instructions to achieve stated acoustic values.

Wall treatments **MUST** be isolated from the floating floor with YELOfon FS50 flanking strip.

Services must not puncture primary ceiling lining (except cables, which should be sealed with flexible sealant).

Table 2T.06b

### Ceiling Treatment Options

**Ceiling boards must not penetrate or touch joists**

16mm (min) metal resilient bars mounted at right angles to the joists at 400mm centres.

**CT1** Two layers of gypsum-based board, composed of 19mm (nominal 13.5kg/m²) fixed with 32mm screws and 12.5mm (nominal 10kg/m²) fixed with 42mm screws, with all joints staggered.

**CT2** Two layers of gypsum-based board, composed of 15mm (nominal 12.5kg/m²) fixed with 25mm screws and a second layer of 15mm (nominal 12.5kg/m²) fixed with 42mm screws, with all joints staggered.

**Plus sacrificial ceiling**

Metal ceiling system with a 150mm (min) void fixed to underside of primary ceiling. One layer of nominal 8kg/m² gypsum based board.

**CT3** 30mm CELLECTA HP30 resilient bars mounted at right angles to the joists at 600mm (max) centres.

Two layers of gypsum-based board, composed of 15mm (nominal 12.5kg/m²) fixed with 25mm screws and a second layer of 15mm (nominal 12.5kg/m²) fixed with 42mm screws, with all joints staggered.

## Acoustic Performance

<b>Airborne:</b>	<b>51dB <math>D_{nT,w} + C_{tr}</math></b>	<b>Building Regs</b>
<b>Impact:</b>	<b>55dB <math>L_{nT,w}</math></b>	<b>+ 5dB</b>

Values quoted are typical and based on the treatment being installed correctly and pre-completion tested (PCT).  
Airborne performance tested in accordance with BS EN ISO 140-4:1998  
Impact performance tested in accordance with BS EN ISO 140-7:1998

## Third Party Accreditation and Approvals



## Environmental Credentials

