

# Metal C-section joist separating floor

## Robust Detail E-FS-3 + UFH

CELLECTA Mojave® acoustic/UFH floating floor system laid on timber sub-deck  
Metal C-section joists and lightweight metal frame walls only

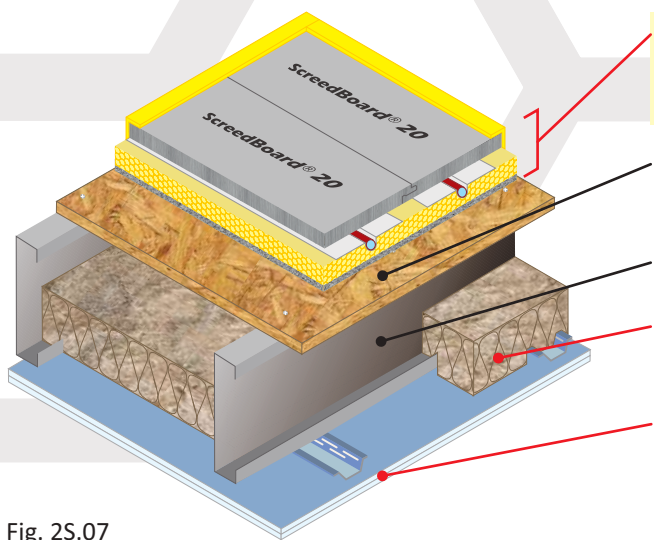

Fig. 2S.07

**Acoustic + UFH treatment**

**CELLECTA Mojave® S1/8** acoustic treatment incorporating underfloor heating (see Table 2S.07a for full details)

**Floor decking**

18mm thick (min) wood based board, density 600kg/m<sup>3</sup>

**Joists**

200mm<sup>(1)</sup> (min) deep metal C-section joists

**Absorbing material**

50mm **CELLECTA FIBREfon® Micro 50**  
100mm (min) quilt insulation (10-36kg/m<sup>3</sup>)

**Ceiling**

See Table 2S.07b for ceiling treatment options featuring 30mm deep **CELLECTA HP30** resilient bars

(1) 254mm(min) required for Robust Detail applications

**FASTRACKCAD**  
ARCHITECTURAL CAD DATABASES

Available on  
bimstore.co

**NSPlus**

Table 2S.07a

### Installation Details

**Resilient overlay platform floor system incorporating underfloor heating**

**Mojave® S1/8**  
Dry laid acoustic treatment incorporating underfloor heating system

- ScreedBoard® 20**  
High conductivity overlay board  
Dimensions: 20mm x 600mm x 1200mm  
Weight: 25kg/m<sup>2</sup> / 18.00kg/board  
Thermal resistance: 0.05m<sup>2</sup>K/W
- CELLECTA Pro Adhesive**  
ScreedBoard joint adhesive  
Bottle size: 1L / 33m<sup>2</sup> coverage
- ULTRAplate**  
Aluminium heat diffuser plate (to suit pipe installed)  
Dimensions: 130mm x 1000mm
- XFLO® 250/300/500**  
High compressive strength routed XPS insulation board  
Dimensions: 15-75mm x 600mm x 2500mm  
Pipe centre: 150, 200, 300mm  
Pipe bore size (OD): 10 - 20mm (manufactured to suit)
- FIBREfon® 8**  
High performance resilient layer  
Dimensions: 8mm x 600mm x 1200mm  
Weight: 1kg/m<sup>2</sup> / 0.72kg/board
- YELOfon® ESS/100**  
Perimeter edge strip  
Dimensions: 5mm x 100mm x 50m
- UFH water pipe (by others)

Additional item required:  
CELLECTA ScreedBoard fixing tools

**CLASS Bfl,S1**  
BS EN13501-1

**housebuilder product awards 2020**  
Best Services Product

Table 2S.07b

### Ceiling Treatment Options

Ceiling board fixings must not penetrate or touch the floor joists  
30mm **CELLECTA HP30** Resilient Bars (3m long) mounted at right angles to the joists at 600mm (max) centres.

**CT1** Two layers of gypsum-based board, composed of 19mm (nominal 13.5kg/m<sup>2</sup>) fixed with 32mm screws and 12.5mm (nominal 10kg/m<sup>2</sup>) fixed with 42mm screws, with all joints staggered.

**CT2** Two layers of gypsum-based board, composed of 15mm (nominal 12.5kg/m<sup>2</sup>) fixed with 25mm screws and a second layer of 15mm (nominal 12.5kg/m<sup>2</sup>) fixed with 42mm screws, with all joints staggered.

**Construction notes**  
Materials must be installed in accordance with manufacturers' and Robust Detail instructions to achieve required acoustic performance values.  
Wall treatments **MUST** be isolated from the floating floor with **YELOfon ESS/100** perimeter flanking strip.

### Acoustic Performance

|                  |   |                      |
|------------------|---|----------------------|
| <b>Airborne:</b> | <b>55dB D<sub>nT,w</sub> + C<sub>tr</sub></b> | <b>Building Regs</b> |
| <b>Impact:</b>   | <b>54dB L<sub>nT,w</sub></b>                  | <b>+ 5dB</b>         |

Values quoted are typical and based on the treatment being installed correctly and pre-completion tested (PCT).  
Airborne performance tested in accordance with BS EN ISO 140-4:1998  
Impact performance tested in accordance with BS EN ISO 140-7:1998

### Third Party Accreditation and Approvals



### Environmental Credentials

