

Cross laminate timber (CLT) separating floor

CELLECTA ScreedBoard® 28 treatment laid on cross laminate timber floor planks

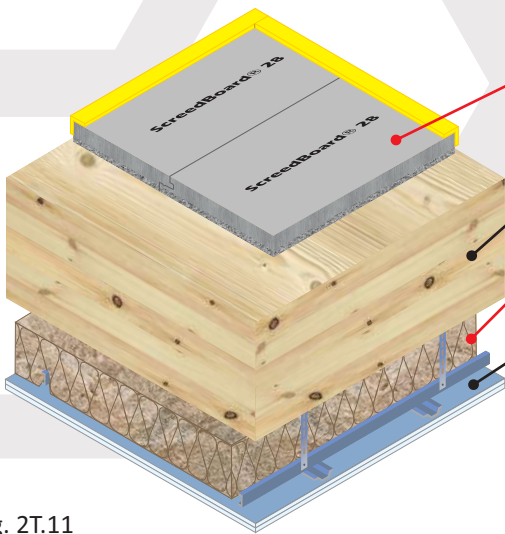

Floating floor treatment

CELLECTA ScreedBoard® 28
(See Table 2T.11a for full details)

Floor planks

200mm (min) CLT floor planks

Absorbing material

- 50mm CELLECTA FIBREfon® Micro 50
- 100mm (min) quilt insulation (10-36kg/m³)

Ceiling

See Table 2T.11b for ceiling treatment options

Fig. 2T.11



Table 2T.11a

Installation Details

Resilient overlay platform floor system

1 ScreedBoard® 28 Ultra high performance, dense acoustic composite overlay board
28mm x 600mm x 1200mm
Weight: 26kg/m² / 18.72kg/board

A CELLECTA Pro Adhesive
ScreedBoard joint adhesive
Bottle size: 1L / 33m² coverage

2 YELOfon® FS50
Preformed flanking strip:
6mm x 50mm x 30mm x 2m

Additional items required:
CELLECTA ScreedBoard fixing tools

Construction notes
Materials must be installed in accordance with manufacturers' instructions to achieve stated acoustic values.
Wall treatments **MUST** be isolated from the floating floor with YELOfon FS50 flanking strip.
Services must not puncture primary ceiling lining (except cables, which should be sealed with flexible sealant).

Table 2T.11b

Ceiling Treatment Options

CELLECTA Ultra Ceiling: Metal frame ceiling system incorporating CELLECTA AH50 acoustic hangers - unique rubber isolated hanger fixed to MF ceiling strap/profile with suitable fixings. 100mm void (min)

Two layers of gypsum-based board, composed of 15mm (nominal 12.5kg/m²) fixed with 25mm screws and a second layer of 15mm (nominal 12.5kg/m²) fixed with 42mm screws, with all joints staggered.

100mm (min)

Any metal frame ceiling system - 150mm void (min)
Two layers of gypsum-based board, composed of 15mm (nominal 12.5kg/m²) fixed with 25mm screws and a second layer of 15mm (nominal 12.5kg/m²) fixed with 42mm screws, with all joints staggered.

150mm (min)

Sound absorbing quilt fitted in ceiling void
50mm CELLECTA FIBREfon Micro 50
100mm (min) mineral wool quilt 10-35kg/m³

Acoustic Performance

Airborne:	50dB $D_{nT,w} + C_{tr}$
Impact:	54dB $L_{nT,w}$

Building Regs
+ 5dB

Values quoted are typical and based on the treatment being installed correctly and pre-completion tested (PCT).
Airborne performance tested in accordance with BS EN ISO 140-4:1998
Impact performance tested in accordance with BS EN ISO 140-7:1998

Third Party Accreditation and Approvals



Environmental Credentials



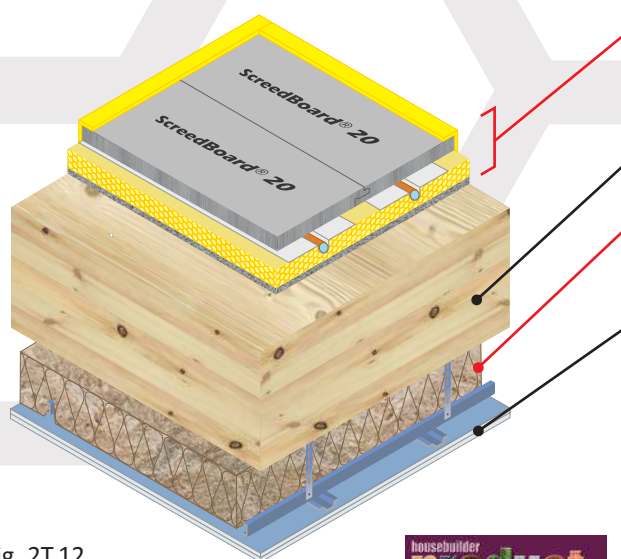

Acoustic + UFH treatment

CELLECTA Mojave® S1/8 acoustic treatment incorporating underfloor heating (see Table 2T.12a for full details)

Floor planks

200mm (min) CLT floor planks

Absorbing material

- 50mm CELLECTA FIBREfon® Micro 50
- 100mm (min) quilt insulation (10-36kg/m³)

Ceiling

See Table 2T.12b for ceiling treatment options

Fig. 2T.12



Table 2T.12a

Table 2T.12b

Installation Details

Resilient overlay platform floor system incorporating underfloor heating

CELLECTA Mojave® S1/8

Dry laid acoustic treatment incorporating underfloor heating system

1 ScreedBoard® 20

High conductivity overlay board
Dimensions: 20mm x 600mm x 1200mm
Weight: 25kg/m² / 18.00kg/board
Thermal resistance: 0.05m²K/W

A CELLECTA Pro Adhesive

ScreedBoard joint adhesive
Bottle size: 1L / 33m² coverage

2 ULTRAplate

Aluminium heat diffuser plate (to suit pipe installed)
Dimensions: 130mm x 1000mm

3 XFLO® 250, 300, 500 (kPa)

High compressive strength routed XPS insulation
Dimensions: 15-75mm x 600mm x 2500mm
Pipe centre: 150, 200, 300mm
Pipe bore size (OD): 10 - 20mm (manufactured to suit)

4 FIBREfon® 8

High performance resilient layer
Dimensions: 8mm x 600mm x 1200mm
Weight: 1kg/m² / 0.72kg/board

5 YELOfon® ES5/100

Perimeter edge strip
Dimensions: 5mm x 100mm x 50mm

P UFH water pipe (by others)

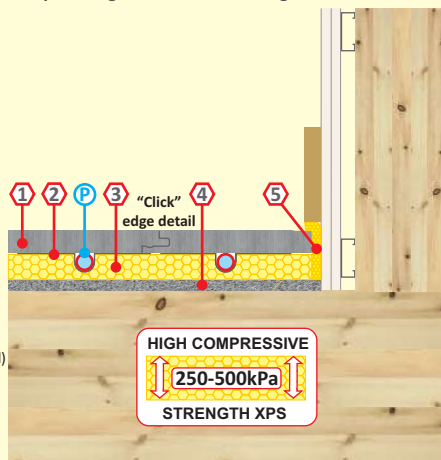

Screedboard 20 is 5x more thermally conductive than an 18mm chipboard + 19mm plasterboard plank combination, enabling the underfloor heating system to be more responsive and the heat source to run more efficiently at a lower temperature.

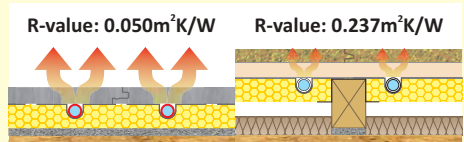

Ceiling Treatment Options

CELLECTA Ultra Ceiling: Metal frame ceiling system incorporating CELLECTA AH50 acoustic hangers - unique rubber isolated hanger fixed to MF ceiling strap/profile with suitable fixings. 100mm void (min)

Two layers of gypsum-based board, composed of 15mm (nominal 12.5kg/m²) fixed with 25mm screws and a second layer of 15mm (nominal 12.5kg/m²) fixed with 42mm screws, with all joints staggered.

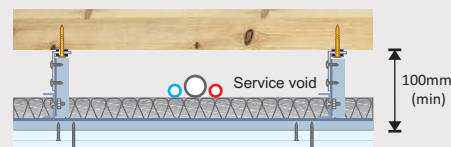

Any metal frame ceiling system - 150mm void (min)

Two layers of gypsum-based board, composed of 15mm (nominal 12.5kg/m²) fixed with 25mm screws and a second layer of 15mm (nominal 12.5kg/m²) fixed with 42mm screws, with all joints staggered.

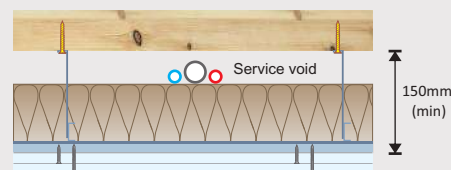

Sound absorbing quilt fitted in ceiling void
• 50mm CELLECTA FIBREfon Micro 50
• 100mm (min) mineral wool quilt 10-35kg/m³

Acoustic Performance

Airborne:	50dB $D_{nT,w} + C_{tr}$
Impact:	54dB $L_{nT,w}$

Building Regs
+ 5dB

Values quoted are typical and based on the treatment being installed correctly and pre-completion tested (PCT).
Airborne performance tested in accordance with BS EN ISO 140-4:1998
Impact performance tested in accordance with BS EN ISO 140-7:1998

Third Party Accreditation and Approvals



Environmental Credentials



01634 29-66-77



collecta.co.uk



technical@collecta.co.uk