

Screed laid on **CELLECTA YELOfon® HD10+** resilient layer *System*
Pre-cast concrete floor plank

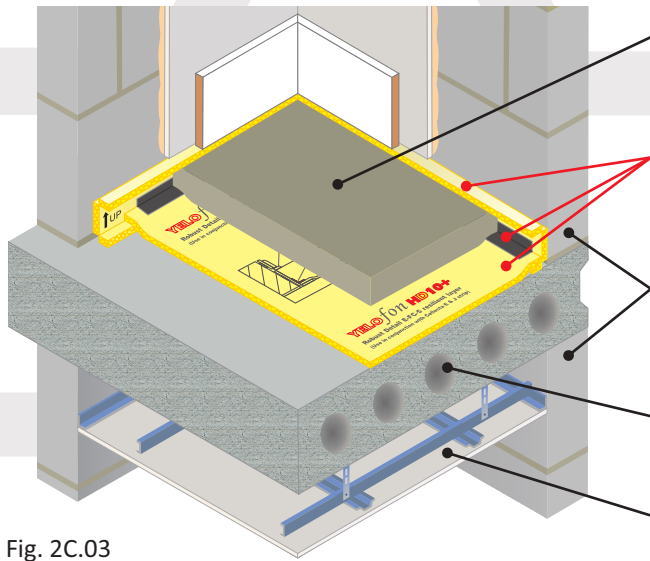

- Floating Screed**
 - 65mm (min) sand cement screed
 - 40mm proprietary screed, nominal 80kg/m² mass per unit area
- 3 part resilient layer system**
 1. **CELLECTA YELOfon® HD10+**
 2. **YELOfon® E-strip** perimeter edge strip
 3. **J-strip** acoustic joining tape
- External flanking walls**
 - 100mm (min) aggregate concrete block 1350-1600kg/m³ or 1850-2300kg/m³
 - 100mm (min) aircrete block 450-800kg/m³
- Structural floor**
 - 150mm (min) pre-cast concrete floor plank
 - 300kg/m² (min) mass per unit area
- Ceiling**

See Table 2C.03b for ceiling treatment options

Fig. 2C.03

Over 12,500,000m² successfully installed



Table 2C.03a

Table 2C.03b

Installation Options

Resilient layer system laid under screed

- YELOfon® HD10+**
High density polyethylene foam with *Surebond* facing
Dimensions: 10mm x 1.5m x 33.33m (50m²)
- YELOfon® J-strip**
Ultra high grab acoustic joining tape
Dimensions: 2.5mm x 75mm x 40m
- YELOfon® E-strip**
Self adhesive perimeter edge strip
Dimensions: 7mm x 200mm x 33m

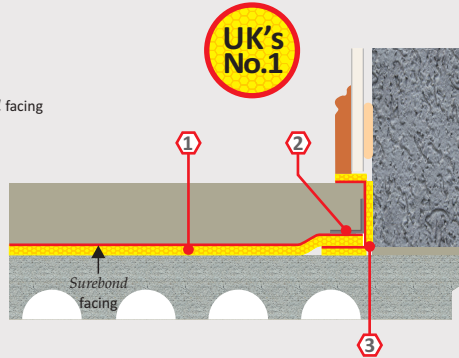

Resilient layer system laid under screed containing underfloor heating system

- HEXATHERM® XFLOOR 250, 300**
High performance extruded polystyrene
Compressive strength: 250, 300kPa
Dimensions: 250 - 20, 25, 30, 35 x 600 x 2500mm
300 - 40, 50, 60, 75, 80, 90, 100, 120, 140, 160 x 600 x 2500mm

UFH water pipe (by others)

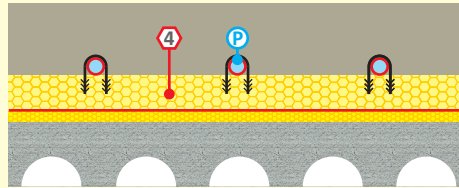

Underfloor heating systems within screed (without thermal insulation)

Proprietary Screeds

When using a proprietary free flowing screed, **HD10+** rolls can be tightly butted together and the joint sealed with **J-strip**. Care should be taken to ensure there are no gaps in the resilient layer. Cover the **HD10+** with a 500 gauge (min) polythene sheet, taping all joins and lapping up around the perimeter by 150mm.

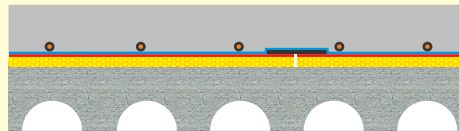

Ceiling Treatment Options

CT0 Metal ceiling - 150mm void

To be used with 150mm (min) depth concrete planks

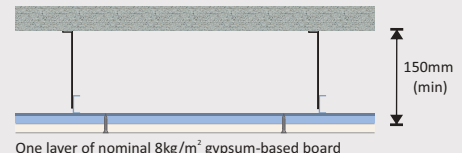

CT1 Metal ceiling - 100mm void

To be used with 200mm (min) depth concrete planks

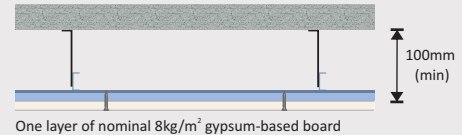

Construction notes

Materials must be installed in accordance with manufacturers' instructions to achieve required acoustic performance values. Wall treatments **must** be isolated from the floating floor with **YELOfon E-Strip** perimeter edge strip.

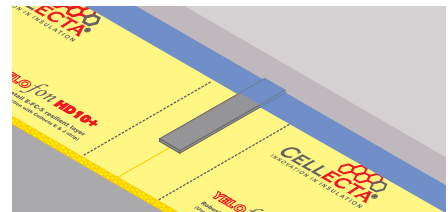

Acoustic Performance

Airborne: 52dB $D_{nT,w} + C_{tr}$

Impact: 54dB $L_{nT,w}$

Building Regs

+ 5dB

Values quoted are typical and based on the treatment being installed correctly and pre-completion tested (PCT).
Airborne performance tested in accordance with BS EN ISO 140-4:1998
Impact performance tested in accordance with BSEN ISO 140-7:1998

Third Party Accreditation and Approvals



Environmental Credentials

