

Solid timber joist separating floor

CELLECTA ScreedBoard® 28 laid on timber sub-floor
Use with timber frame walls only

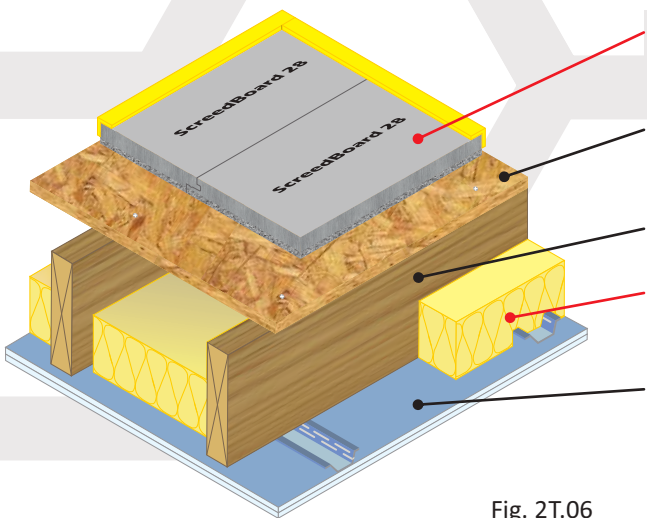

Fig. 2T.06

Floating floor treatment	FFT1 - CELLECTA DECKfon® Batten 70 (See Table 2T.06a & b for full details)
Floor decking	11mm (min) thick wood based board, density 600kg/m³ (min)
Joists	220mm (min) solid timber joists
Absorbing material	○ 50mm CELLECTA FIBREfon® Micro 50 ● 100mm (min) quilt insulation (10-36kg/m³)
Ceiling	See Table 2T.06b for ceiling treatment options



Table 2T.06a

Installation Details

Resilient overlay platform floor system

1 ScreedBoard® 28

Ultra high performance, dense acoustic composite overlay board

28mm x 600mm x 1200mm

Weight: 26kg/m² / 18.72kg/board

A CELLECTA Pro Adhesive

ScreedBoard joint adhesive

Bottle size: 1L / 33m² coverage

2 YELOfon® FS50

Preformed flanking strip:

6mm x 50mm x 30mm x 2m

Additional items required:

CELLECTA ScreedBoard® fixing tools

Sound absorbing quilt laid between joists:

○ 50mm CELLECTA FIBREfon® Micro 50 non-itch polyester wool

● 100mm (min) Mineral wool 10-33kg/m³

Construction notes

Materials must be installed in accordance with manufacturers' instructions to achieve stated acoustic values.

Wall treatments **MUST** be isolated from the floating floor with YELOfon FS50 flanking strip.

Services must not puncture primary ceiling lining (except cables, which should be sealed with flexible sealant).

Table 2T.06b

Ceiling Treatment Options

Ceiling boards must not penetrate or touch joists

16mm (min) metal resilient bars mounted at right angles to the joists at 400mm centres.

CT1 Two layers of gypsum-based board, composed of 19mm (nominal 13.5kg/m²) fixed with 32mm screws and 12.5mm (nominal 10kg/m²) fixed with 42mm screws, with all joints staggered.

CT2 Two layers of gypsum-based board, composed of 15mm (nominal 12.5kg/m²) fixed with 25mm screws and a second layer of 15mm (nominal 12.5kg/m²) fixed with 42mm screws, with all joints staggered.

Plus sacrificial ceiling

Metal ceiling system with a 150mm (min) void fixed to underside of primary ceiling. One layer of nominal 8kg/m² gypsum based board.

CT3 30mm CELLECTA HP30 resilient bars mounted at right angles to the joists at 600mm (max) centres.

Two layers of gypsum-based board, composed of 15mm (nominal 12.5kg/m²) fixed with 25mm screws and a second layer of 15mm (nominal 12.5kg/m²) fixed with 42mm screws, with all joints staggered.

Acoustic Performance

Airborne: 51dB $D_{nT,w} + C_{tr}$	Building Regs
Impact: 55dB $L_{nT,w}$	+ 5dB

Values quoted are typical and based on the treatment being installed correctly and pre-completion tested (PCT).
Airborne performance tested in accordance with BS EN ISO 140-4:1998
Impact performance tested in accordance with BS EN ISO 140-7:1998

Third Party Accreditation and Approvals



Environmental Credentials

