

**CELLECTA DECKfon® ULTRAlay 5 acoustic floor covering adhered to screed**  
**Screed laid on CELLECTA isolation layers**

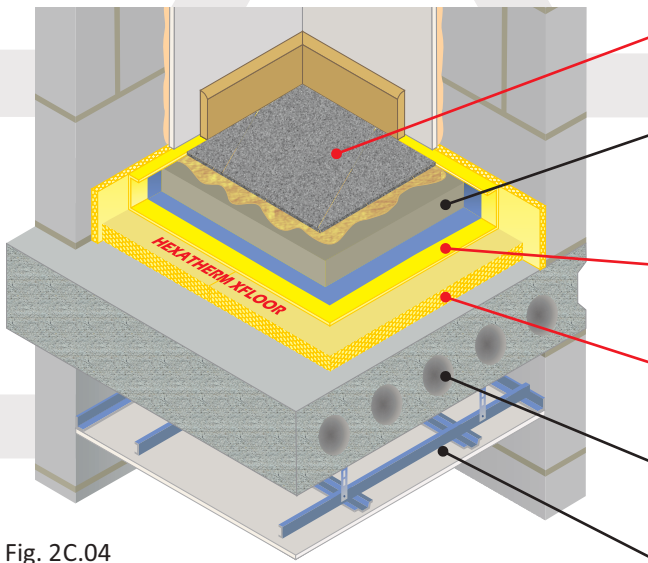

- Resilient layer** 5mm **DECKfon® ULTRAlay 5** acoustic floor covering fully bonded to screed
- Floating screed**
  - 65mm (min) sand cement screed
  - 40mm proprietary screed, nominal 80kg/m<sup>2</sup> mass per unit area
- 1<sup>st</sup> Isolation layer** 5mm **CELLECTA YELOfon® HD5** extruded polyethylene (30kg/m<sup>3</sup>)
- 2<sup>nd</sup> Isolation layer** 25mm (min) **CELLECTA XFLOOR 250, 300** extruded polystyrene insulation board
- Structural floor**
  - 150mm (min) pre-cast concrete floor plank
  - 300kg/m<sup>2</sup> (min) mass per unit area
- Ceiling** See Table 2C.04b for ceiling treatment options

Fig. 2C.04



Table 2C.04a

### Installation Options

**Resilient layer bonded to screed**

- 1** **DECKfon® ULTRAlay 5**  
High density recycled acoustic floor covering  
Dimensions: 5mm x 1.2m x 10m (12m<sup>2</sup>)
- A** **CELLECTA HB724**  
High bond floor adhesive  
Coverage: 14kg / 46m<sup>2</sup>

**Resilient layers under screed**

- 2** **YELOfon® HD5**  
5mm extruded polyethylene (30kg/m<sup>3</sup>)  
Dimensions: 5mm x 1.5m x 75m (112.5m<sup>2</sup>)
- 3** **HEXATHERM® XFLOOR 250, 300**  
High performance extruded polystyrene  
Compressive strength: 250, 300kPa  
Dimensions: 20-160mm x 600mm x 2500mm
- 4** **YELOfon® ES10/100**  
Perimeter edge strip  
Dimensions: 10mm x 100mm x 50m

**IMPORTANT**  
 If adopting this treatment, all four components **MUST** be installed:  
 1) **DECKfon ULTRAlay 5** (acoustic floor covering)  
 2) **YELOfon HD5** (isolation layer 1)  
 3) **HEXATHERM XFLOOR 250, 300** (isolation layer 2)  
 4) **YELOfon ES10/100** (perimeter edge strip)

**Underfloor heating system incorporated within screed**

**P** UFH water pipe (by others)

**Construction notes**  
 Materials must be installed in accordance with manufacturers' instructions to achieve stated acoustic values.  
 Wall treatments **MUST** be isolated from the floating floor with **YELOfon HD5** and **ES10/100** perimeter edge strip.

Table 2C.04b

### Ceiling Treatment Options

**CT0 Metal ceiling - 150mm void**  
 To be used with 150mm (min) depth concrete planks

One layer of nominal 8kg/m<sup>2</sup> gypsum-based board

**CT1 Metal ceiling - 100mm void**  
 To be used with 200mm (min) depth concrete planks

One layer of nominal 8kg/m<sup>2</sup> gypsum-based board

*rd* impact performance values quoted were conducted at Sound Research Laboratories (UKAS ref. 0444) in accordance with BS EN ISO 10140-3 and BS EN ISO 10140-4 and rated in accordance with BS EN ISO 717-2:2013 as detailed in Appendix D of the Robust Details hand book (minimum value required *rd ΔL<sub>w</sub>* = 17dB).  
 PCT values quoted are typical, based on the treatment being installed correctly and pre-completion tested, with airborne performance tested in accordance with BS EN ISO 140-4:1998 and impact performance tested in accordance with BS EN ISO 140-7:

**Acoustic Performance**

**Airborne:** 52dB  $D_{nT,w} + C_{tr}$

**Impact:** 40dB  $L_{nT,w}$   
 $rd \Delta L_w = 31dB$

**Building Regs**  
 + 5dB

**Third Party Accreditation and Approvals**

**RD**  
 Compliant Treatment

**NHBC**  
**LABC warranty**  
**Premier Guarantee**  
 Accepted

**bimtrack**  
 2015

**GWP**  
 <5

**100%**  
 Recyclable  
 Foam

**zero**  
 ODP