

Pre-cast concrete plank separating floor

Robust Detail E-FC-17

Screed laid on **CELLECTA YELOfon® HD10+** resilient layer *System* incorporating **CELLECTA ULTRA** ceiling treatment

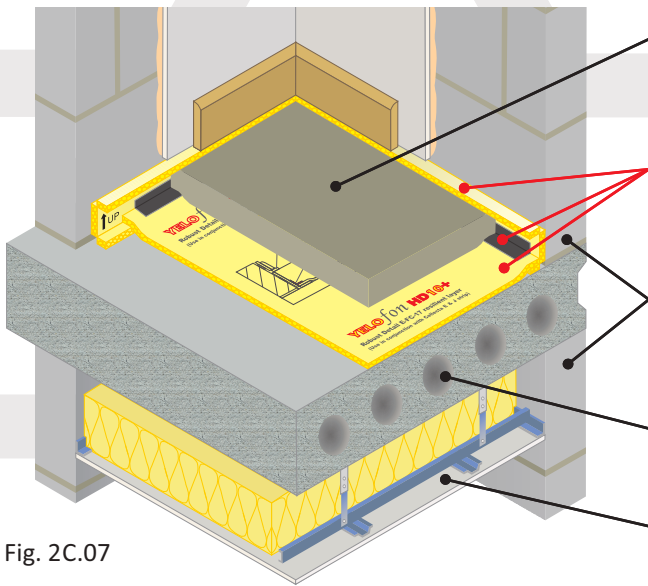

- Floating screed**
 - 65mm (min) sand cement screed
 - 40mm proprietary screed, nominal 80kg/m² mass per unit area
- 3 part resilient layer system**
 1. **CELLECTA YELOfon® HD10+**
 2. **YELOfon® E-strip** perimeter edge strip
 3. **J-strip** acoustic joining tape
- External flanking walls**
 - 100mm (min) aggregate concrete block 1350-1600kg/m³ or 1850-2300kg/m³
 - 100mm (min) aircrete block 450-800kg/m³
- Structural floor**
 - 150mm (min) pre-cast concrete floor plank
 - 300kg/m² (min) mass per unit area
- Ceiling**

See Table 2C.07b for ceiling treatment

Fig. 2C.07

Over 12,500,000m² successfully installed



Table 2C.07a

Table 2C.07b

Installation Options

Resilient layer system laid under screed

1. **YELOfon® HD10+**
High density polyethylene foam with *Surebond* facing
Dimensions: 10mm x 1.5m x 33.33m (50m²)
2. **YELOfon® J-strip**
Ultra high grab acoustic joining tape
Dimensions: 2.5mm x 75mm x 40m
3. **YELOfon® E-strip**
Self adhesive perimeter edge strip
Dimensions: 7mm x 200mm x 33m

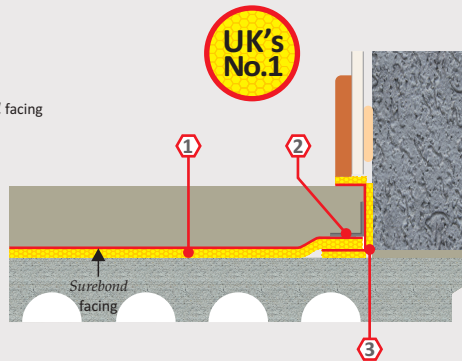

Resilient layer system laid under screed containing underfloor heating system

4. **HEXATHERM® XFLOOR 250, 300**
High performance extruded polystyrene
Compressive strength: 250, 300kPa
Dimensions: 250 - 20, 25, 30, 35 x 600 x 2500mm
300 - 40, 50, 60, 75, 80, 90, 100, 120, 140, 160 x 600 x 2500mm

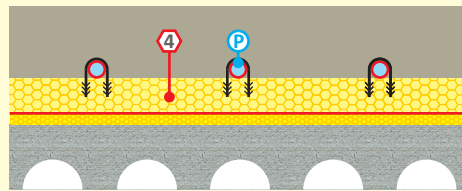

UFH water pipe (by others)

Underfloor heating systems within screed (without thermal insulation)

Proprietary Screeds

When using a proprietary free flowing screed, **HD10+** rolls can be tightly butted together and the joint sealed with **J-strip**. Care should be taken to ensure there are no gaps in the resilient layer. Cover the **HD10+** with a 500 gauge (min) polythene sheet, taping all joins and lapping up around the perimeter by 150mm.

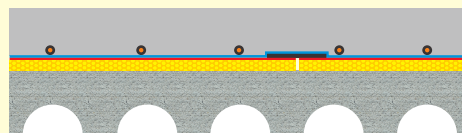

Ensure fixings used to secure the UFH **do not** penetrate the **HD10+**

Ceiling Treatment Options

CELLECTA ULTRA Ceiling: Metal frame ceiling system incorporating **CELLECTA AH50** acoustic hangers
Unique rubber isolated hanger fixed to MF ceiling strap/profile with suitable fixings

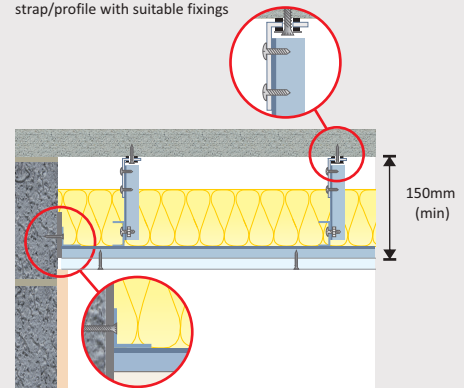

One layer of 15mm nominal 10kg/m² gypsum-based board

CELLECTA C-strip
Self adhesive acoustic flanking strip stuck around the perimeter walls to isolate the ceiling
Dimensions: 5mm x 75mm x 10m

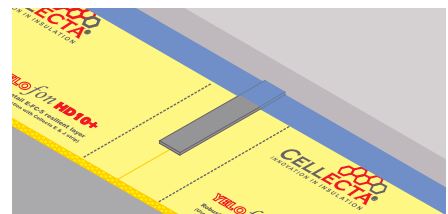

Acoustic Performance

Airborne: 52dB $D_{nT,w} + C_{tr}$	Building Regs
Impact: 52dB $L_{nT,w}$	+ 5dB

Values quoted are typical and based on the treatment being installed correctly and pre-completion tested (PCT).
Airborne performance tested in accordance with BS EN ISO 140-4:1998
Impact performance tested in accordance with BSEN ISO 140-7:1998

Third Party Accreditation and Approvals



Environmental Credentials

