

Pre-cast concrete plank separating floor

Robust Detail E-FC-1

CELLECTA floating floor treatment laid on pre-cast concrete plank with fully bonded screed

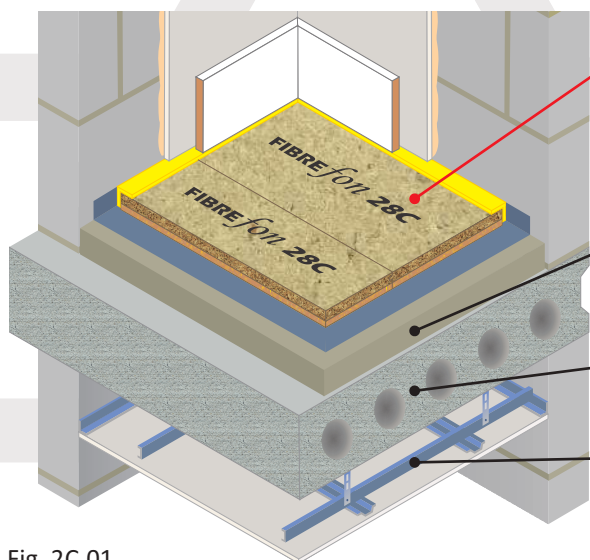

Fig. 2C.01

Floating floor
acoustic treatment
options

- FFT1 - CELLECTA DECKfon® Batten 70
- FFT2 - CELLECTA RUBBERfon® Cradles
- FFT3 - CELLECTA DECKfon® Batten 45
- FFT4 - CELLECTA ScreedBoard® 30
- FFT5 - CELLECTA FIBREfon® 12C, 21C, 28C

Screed

40mm (min) screed directly applied to plank.
Sand: cement or proprietary screed 80kg/m²
(min) mass per unit area

Structural floor

- 150mm (min) pre-cast concrete floor plank
- 300kg/m² (min) mass per unit area

Ceiling

See Table 2C.01a for ceiling treatment options

Table 2C.01a

FASTRACKCAD
ARCHITECTURAL CAD DATABASES

n55Plus

Available on
bimstore.co

Ceiling Treatment Options

CT1 Metal ceiling - 100mm void

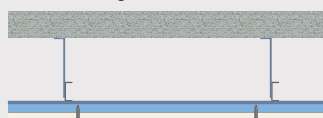

One layer of nominal 8kg/m² gypsum-based board

100mm (min)

CT2 Timber batten & counter battens

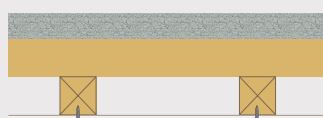

One layer of nominal 8kg/m² gypsum-based board

100mm (min)

CT3 Metal ceiling - 75mm void

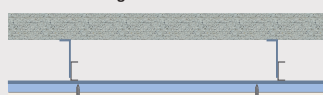

One layer of nominal 10kg/m² gypsum-based board

75mm (min)

CT4 Timber batten & metal resilient bars

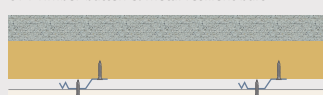

One layer of nominal 10kg/m² gypsum-based board

65mm (min)

Acoustic Performance

Rd impact performance values quoted were conducted at Sound Research Laboratories (UKAS ref. 0444) in accordance with BS EN ISO 10140-3 and BS EN ISO 10140-4 and rated in accordance with BS EN ISO 717-2:2013 as detailed in Appendix D of the Robust Details hand book (minimum value required $rd \Delta L_w = 17dB$).
PCT values quoted are typical, based on the treatment being installed correctly and pre-completion tested, with airborne performance tested in accordance with BS EN ISO 140-4:1998 and impact performance tested in accordance with BS EN ISO 140-7: 1998.

Third Party Accreditation and Approvals

RD
Compliant
Treatments
BBA
VERIFIED
RD DATA

NHBC
LABC warranty
Premier Guarantee
Accepted

bimtrada
2015

GWP
≤5

100%
Recyclable
Recycled

zero
ODP

Table 2C.01b

FFT1 Resilient composite deep batten system**1** DECKfon® Batten 70

Deep acoustic batten: 75mm x 45mm x 2400mm
 *Height indicated when floor is loaded to 25kg/m²

2 YELOfon® ES5/120

Perimeter edge strip: 5mm x 120mm x 50m

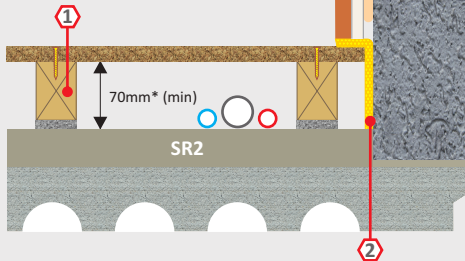

Airborne
54dB $D_{nT,w} + C_{tr}$

Impact
47dB $L_{nT,w}$
 $rd \Delta L_w = 27dB$

Building Regs
 $\geq +8dB$

BBA VERIFIED
RD DATA

Additional item required to complete treatment: 18mm (min) tongue & groove flooring board

Table 2C.01e

FFT4 Resilient overlay platform floor system**1** ScreedBoard® 30

high performance, dense acoustic composite overlay board
 Dimensions: 30mm x 600mm x 1200mm
 Weight: 27.20kg/m² / 19.58kg/board

2 YELOfon® FS50

Preformed flanking strip:
 6mm x 50mm x 30mm x 2m

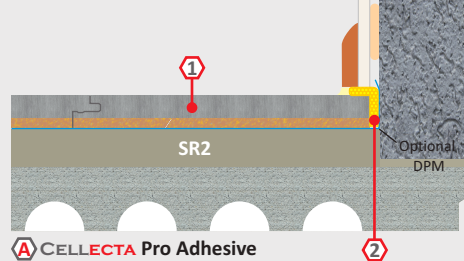

Airborne
52dB $D_{nT,w} + C_{tr}$

Impact
52dB $L_{nT,w}$
 $rd \Delta L_w = 22dB$

Building Regs
 $\geq +8dB$

BBA VERIFIED
RD DATA

CLASS Bfl, S1
BS EN13501-1

A CELLECTA Pro Adhesive
 ScreedBoard joint adhesive
 Bottle size: 1L / 33m²

Additional items required: ScreedBoard fixing tools

Table 2C.01c

FFT2 Resilient cradle and batten levelling system**1** RUBBERfon® Cradles

Dimensions: 10mm high x 100mm x 100mm
 Levelling packers: 2, 3 & 5mm
 Elevation blocks: 15 & 30mm

2 CELLECTA Softwood timber batten

Standard dimensions: 40, 65mm⁽²⁾
 x 45mm x 2400mm

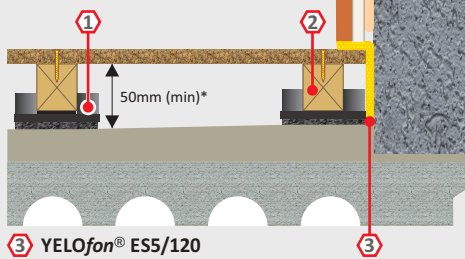

Airborne
52dB $D_{nT,w} + C_{tr}$

Impact
49dB $L_{nT,w}$
 $rd \Delta L_w = 25dB$

Building Regs
 $+5dB$

BBA VERIFIED
RD DATA

3 YELOfon® ES5/120
 Perimeter edge strip: 5mm x 120mm x 50m

Additional item required to complete treatment: 18mm (min) tongue & groove flooring board.
⁽²⁾ Other height battens available upon request. *Height indicated when floor is loaded to 25kg/m²

Table 2C.01f

FFT5 Resilient shallow overlay platform floor system**1** FIBREfon® 12C, 21C, 28C

12C: 12mm x 600mm x 2400mm
 21C: 21mm x 600mm x 2400mm
 28C: 28mm x 600mm x 2400mm

2 12C: YELOfon® ES5/60

Perimeter edge strip: 5mm x 60mm x 50m

21C, 28C: YELOfon® FS30

Pre-formed flanking strip:
 6mm x 30mm x 30mm x 2m

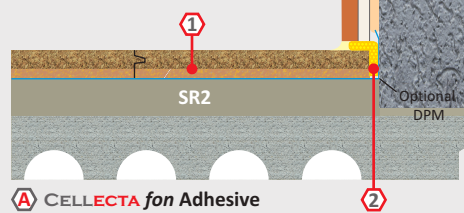

12C Airborne
50dB $D_{nT,w} + C_{tr}$

12C Impact
53dB $L_{nT,w}$
 $rd \Delta L_w = 21dB$

21C Airborne
50dB $D_{nT,w} + C_{tr}$

21C Impact
56dB $L_{nT,w}$
 $rd \Delta L_w = 18dB$

28C Airborne
50dB $D_{nT,w} + C_{tr}$

28C Impact
53dB $L_{nT,w}$
 $rd \Delta L_w = 21dB$

A CELLECTA fon Adhesive
 Floorboard joint adhesive
 Bottle size: 1L / 33m²

Building Regs
 $\geq +5dB$

Table 2C.01d

FFT3 Resilient composite standard batten system**1** DECKfon® Batten 45

Standard acoustic batten: 50mm x 45mm x 2400mm
 *Height indicated when floor is loaded to 25kg/m²

2 YELOfon® ES5/100

Perimeter edge strip: 5mm x 100mm x 50m

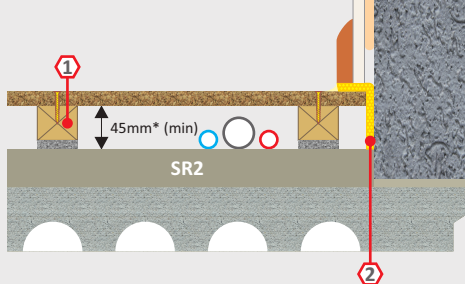

Airborne
52dB $D_{nT,w} + C_{tr}$

Impact
49dB $L_{nT,w}$
 $rd \Delta L_w = 25dB$

Building Regs
 $+5dB$

BBA VERIFIED
RD DATA

Additional item required to complete treatment: 18mm (min) tongue & groove flooring board

Construction notes

Ceiling treatments detailed can be used with any FFT listed in Table 2C.01b-f. Slab/levelling screed must be to SR2 Standard when adopting FFT1, 3, 4 or 5. No services should be installed within the treatment when adopting FFT5.

Materials must be installed in accordance with manufacturers' and Robust Detail instructions to achieve required acoustic performance values. Wall treatments MUST be isolated from the floating floor with YELOfon ES or FS perimeter flanking strip.