

Timber I-joist separating floor

Robust Detail E-FT-5

CELLECTA ScreedBoard® 28 laid on timber sub-floor
Use with timber frame walls only

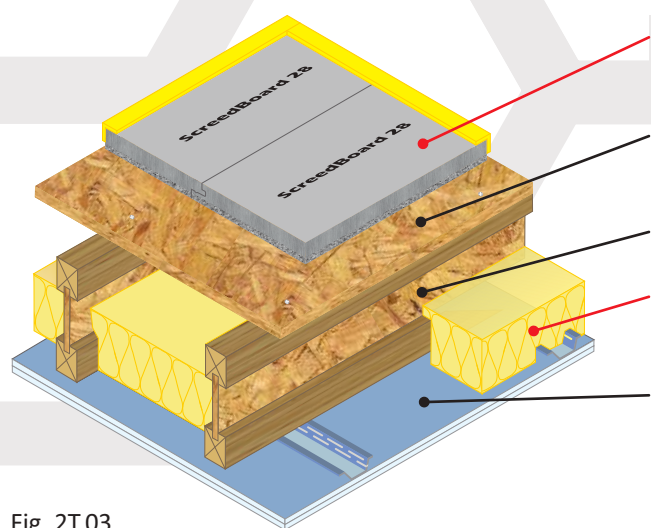

Floating floor treatment

CELLECTA ScreedBoard® 28
(See Table 2T.03a for full details)

Floor decking

15mm⁽¹⁾ (min) thick wood based board, density 600kg/m³ (min)

Joists

235mm⁽²⁾ (min) timber I-joists

Absorbing material

○ 50mm CELLECTA FIBREfon® Micro 50
● 100mm (min) quilt insulation (10-36kg/m³)

Ceiling

See Table 2T.03b for ceiling treatment options

⁽¹⁾ 18mm (min) required for Robust Detail applications

⁽²⁾ 240mm (min) required for Robust Detail applications when adopting CT3 ceiling treatment

Fig. 2T.03

FASTRACKCAD
ARCHITECTURAL CAD DATABASES

Available on
bimstore.co

NSPlus

Table 2T.03a

Installation Details

Resilient overlay platform floor system

- ScreedBoard® 28** Ultra high performance, dense acoustic composite overlay board
28mm x 600mm x 1200mm
Weight: 26kg/m² / 18.72kg/board
- CELLECTA Pro Adhesive**
ScreedBoard joint adhesive
Bottle size: 1L / 33m² coverage
- YELOfon® FS50**
Preformed flanking strip:
6mm x 50mm x 30mm x 2m

Additional items required:
CELLECTA ScreedBoard® fixing tools
Sound absorbing quilt laid between joists:
○ 50mm CELLECTA FIBREfon® Micro 50 non-itch polyester wool
● 100mm (min) Mineral wool 10-33kg/m³

Construction notes
Materials must be installed in accordance with manufacturers' instructions to achieve stated acoustic values.
Wall treatments **MUST** be isolated from the floating floor with YELOfon FS50 flanking strip.
Services must not puncture primary ceiling lining (except cables, which should be sealed with flexible sealant).

Table 2T.03b

Ceiling Treatment Options

Ceiling boards must not penetrate or touch joists
16mm (min) metal resilient bars mounted at right angles to the joists at 400mm centres.

CT1 Two layers of gypsum-based board, composed of 19mm (nominal 13.5kg/m²) fixed with 32mm screws and 12.5mm (nominal 10kg/m²) fixed with 42mm screws, with all joints staggered.

CT2 Two layers of gypsum-based board, composed of 15mm (nominal 12.5kg/m²) fixed with 25mm screws and a second layer of 15mm (nominal 12.5kg/m²) fixed with 42mm screws, with all joints staggered.

Plus sacrificial ceiling
Metal ceiling system with a 150mm (min) void fixed to underside of primary ceiling. One layer of nominal 8kg/m² gypsum based board.

CT3 30mm CELLECTA HP30 resilient bars mounted at right angles to the joists at 600mm (max) centres.

Two layers of gypsum-based board, composed of 15mm (nominal 12.5kg/m²) fixed with 25mm screws and a second layer of 15mm (nominal 12.5kg/m²) fixed with 42mm screws, with all joints staggered.

Acoustic Performance

Airborne: 51dB $D_{nT,w} + C_{tr}$
Impact: 55dB $L_{nT,w}$

Building Regs
+ 5dB

Values quoted are typical and based on the treatment being installed correctly and pre-completion tested (PCT).
Airborne performance tested in accordance with BS EN ISO 140-4:1998
Impact performance tested in accordance with BS EN ISO 140-7:1998

Third Party Accreditation and Approvals

RD
Proprietary Treatment

NHBC
LABC warranty
Premier Guarantee
Accepted

bimtrada
2015

CLASS Bfl,S1
BS EN13501-1
2017

Environmental Credentials

GWP
<5

100%
Recyclable
Gypsum

