

Metal web joist separating floor

Robust Detail E-FT-6

CELLECTA ScreedBoard® 28 laid on timber sub-floor
Use with timber frame walls only

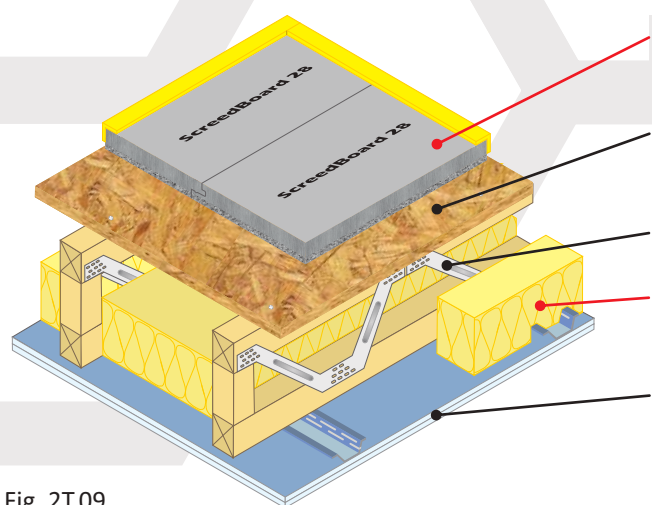

Fig. 2T.09

Floating floor treatment	CELLECTA ScreedBoard® 28 (See Table 2T.09a for full details)
Floor decking	15mm ⁽¹⁾ (min) thick wood based board, density 600kg/m ³ (min)
Joists	253mm (min) metal web joists
Absorbing material	<ul style="list-style-type: none"> 50mm CELLECTA FIBREfon® Micro 50 100mm (min) quilt insulation (10-36kg/m³)
Ceiling	See Table 2T.09b for ceiling treatment options

FASTRACKCAD
ARCHITECTURAL CAD DATABASES

Available on
bimstore.co

n55Plus

Table 2T.09a

Installation Details

Resilient overlay platform floor system

- ScreedBoard® 28** Ultra high performance, dense acoustic composite overlay board
28mm x 600mm x 1200mm
Weight: 26kg/m² / 18.72kg/board
- CELLECTA Pro Adhesive**
ScreedBoard joint adhesive
Bottle size: 1L / 33m² coverage
- YELOfon® FS50**
Preformed flanking strip:
6mm x 50mm x 30mm x 2m

Additional items required:
CELLECTA ScreedBoard® fixing tools
Sound absorbing quilt laid between joists:

- 50mm CELLECTA FIBREfon® Micro 50 non-itch polyester wool
- 100mm (min) Mineral wool 10-33kg/m³

Construction notes
Materials must be installed in accordance with manufacturers' instructions to achieve stated acoustic values.
Wall treatments **MUST** be isolated from the floating floor with YELOfon FS50 flanking strip.
Services must not puncture primary ceiling lining (except cables, which should be sealed with flexible sealant).

Table 2T.09b

Ceiling Treatment Options

Ceiling boards must not penetrate or touch joists
16mm (min) metal resilient bars mounted at right angles to the joists at 400mm centres.

CT1 Two layers of gypsum-based board, composed of 19mm (nominal 13.5kg/m²) fixed with 32mm screws and 12.5mm (nominal 10kg/m²) fixed with 42mm screws, with all joints staggered.

CT2 Two layers of gypsum-based board, composed of 15mm (nominal 12.5kg/m²) fixed with 25mm screws and a second layer of 15mm (nominal 12.5kg/m²) fixed with 42mm screws, with all joints staggered.

Plus sacrificial ceiling
Metal ceiling system with a 150mm (min) void fixed to underside of primary ceiling. One layer of nominal 8kg/m² gypsum based board.

CT3 - 30mm CELLECTA HP30 resilient bars mounted at right angles to the joists at 600mm (max) centres.

Two layers of gypsum-based board, composed of 15mm (nominal 12.5kg/m²) fixed with 25mm screws and a second layer of 15mm (nominal 12.5kg/m²) fixed with 42mm screws, with all joints staggered.

Additional items required:
CELLECTA ScreedBoard fixing tools

Acoustic Performance

Airborne: 53dB $D_{nT,w} + C_{tr}$	Building Regs
Impact: 55dB $L_{nT,w}$	+ 5dB

Values quoted are typical and based on the treatment being installed correctly and pre-completion tested (PCT).
Airborne performance tested in accordance with BS EN ISO 140-4:1998
Impact performance tested in accordance with BS EN ISO 140-7:1998

Third Party Accreditation and Approvals



Environmental Credentials

