

Cross laminate timber (CLT) separating floor

CELLECTA ScreedBoard® 28 treatment laid on cross laminate timber floor planks

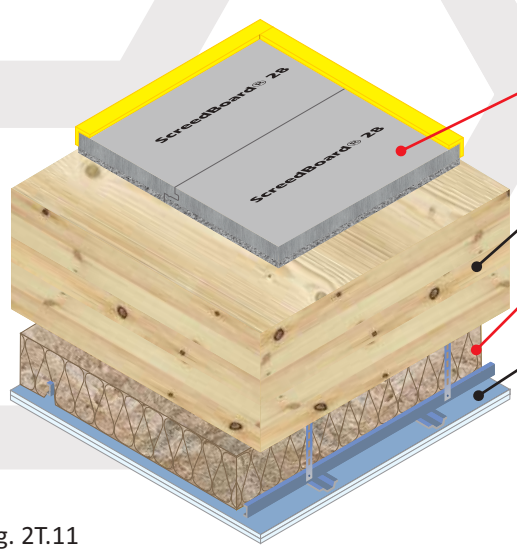

- Floating floor treatment**
CELLECTA ScreedBoard® 28
(See Table 2T.11a for full details)
- Floor planks**
200mm (min) CLT floor planks
- Absorbing material**
 - 50mm CELLECTA FIBREfon® Micro 50
 - 100mm (min) quilt insulation (10-36kg/m³)
- Ceiling**
See Table 2T.11b for ceiling treatment options

Fig. 2T.11

FASTRACKCAD
ARCHITECTURAL CAD DATABASES

Available on
bimstore.co

NSPlus

Table 2T.11a

Installation Details
Resilient overlay platform floor system

1

ScreedBoard® 28 Ultra high performance, dense acoustic composite overlay board
28mm x 600mm x 1200mm
Weight: 26kg/m² / 18.72kg/board

A

CELLECTA Pro Adhesive
ScreedBoard joint adhesive
Bottle size: 1L / 33m² coverage

2

YELOfon® FS50
Preformed flanking strip:
6mm x 50mm x 30mm x 2m

Additional items required:
CELLECTA ScreedBoard fixing tools

Construction notes
Materials must be installed in accordance with manufacturers' instructions to achieve stated acoustic values.
Wall treatments **MUST** be isolated from the floating floor with YELOfon FS50 flanking strip.
Services must not puncture primary ceiling lining (except cables, which should be sealed with flexible sealant).

Table 2T.11b

Ceiling Treatment Options

CELLECTA Ultra Ceiling: Metal frame ceiling system incorporating CELLECTA AH50 acoustic hangers - unique rubber isolated hanger fixed to MF ceiling strap/profile with suitable fixings. 100mm void (min)

Two layers of gypsum-based board, composed of 15mm (nominal 12.5kg/m²) fixed with 25mm screws and a second layer of 15mm (nominal 12.5kg/m²) fixed with 42mm screws, with all joints staggered.

Any metal frame ceiling system - 150mm void (min)

Two layers of gypsum-based board, composed of 15mm (nominal 12.5kg/m²) fixed with 25mm screws and a second layer of 15mm (nominal 12.5kg/m²) fixed with 42mm screws, with all joints staggered.

Sound absorbing quilt fitted in ceiling void

- 50mm CELLECTA FIBREfon Micro 50
- 100mm (min) mineral wool quilt 10-35kg/m³

Acoustic Performance

Airborne: 50dB $D_{nT,w} + C_{tr}$

Impact: 54dB $L_{nT,w}$

Building Regs
+ 5dB

Values quoted are typical and based on the treatment being installed correctly and pre-completion tested (PCT).
Airborne performance tested in accordance with BS EN ISO 140-4:1998
Impact performance tested in accordance with BS EN ISO 140-7:1998

Third Party Accreditation and Approvals

NHBC
LABC warranty
Premier Guarantee
Accepted

2015

BS EN13501-1
2017

Environmental Credentials