

Pre-cast concrete plank separating floor

Acoustic + UFH

Screed laid on **CELLECTA** resilient layers

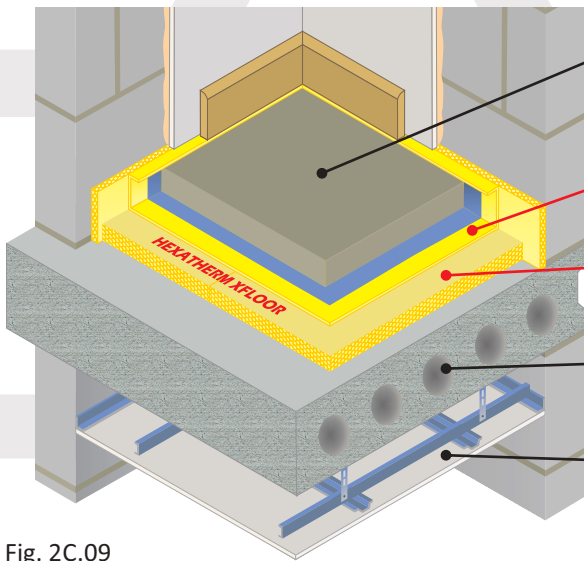

- Floating screed**
 - 65mm (min) sand cement screed
 - 40mm proprietary screed, nominal 80kg/m² mass per unit area
- 1st Isolation layer** 5mm **CELLECTA YELOfon**[®] HD5 extruded polyethylene (30kg/m³)
- 2nd Isolation layer** 25mm (min) **CELLECTA XFLOOR 250, 300** extruded polystyrene insulation board
- Structural floor**
 - 150mm (min) pre-cast concrete floor plank
 - 300kg/m² (min) mass per unit area
- Ceiling** See Table 2C.09b for ceiling treatment options

Fig. 2C.09



Table 2C.09a

Installation Options

Resilient layers under screed

- 1 YELOfon[®] HD5**
5mm extruded polyethylene (30kg/m³)
Dimensions: 5mm x 1.5m x 75m (112.5m²)
- 2 HEXATHERM[®] XFLOOR 250, 300**
High performance extruded polystyrene
Compressive strength: 250, 300kPa
Dimensions: 250 - 20, 25, 30, 35 x 600 x 2500mm
300 - 40, 50, 60, 75, 80, 90, 100, 120, 140, 160 x 600 x 2500mm
- 3 YELOfon[®] ES10/100**
Perimeter edge strip
Dimensions: 10mm x 100mm x 50mm

IMPORTANT
If adopting this treatment, all three our components must be installed:

- 1) YELOfon HD5 (isolation layer 1)
- 2) HEXATHERM XFLOOR 250, 300 (isolation layer 2)
- 3) YELOfon ES10/100 (perimeter edge strip)

Underfloor heating system incorporated within screed

P UFH water pipe (by others)

Table 2C.09b

Ceiling Treatment Options

Any metal frame ceiling system providing 100mm (min) ceiling void

100mm (min)

Timber battens & counter battens

100mm (min)

One layer of nominal 8kg/m² gypsum-based board

Timber battens & metal resilient bars

65mm (min)

One layer of nominal 10kg/m² gypsum-based board

Construction notes
Materials must be installed in accordance with manufacturers' instructions to achieve stated acoustic values.
Wall treatments **MUST** be isolated from the floating floor with **YELOfon** HD5 and ES10/100 perimeter edge strip.

Acoustic Performance

Airborne:	54dB $D_{nT,w} + C_{tr}$	Building Regs
Impact:	54dB $L_{nT,w}$	+ 5dB

Values quoted are typical and based on the treatment being installed correctly and pre-completion tested (PCT).
Airborne performance tested in accordance with BS EN ISO 140-4:1998
Impact performance tested in accordance with BSEN ISO 140-7:1998

Third Party Accreditation and Approvals



Environmental Credentials

