

# Intermediate floor - Steel-concrete composite

CELLECTA **ScreedBoard 20** installed on CELLECTA **XFLO** underfloor heating insulation boards  
Laid on levelled uneven structural floor  
Dry system

WU9.isc2

**DRY**  
System

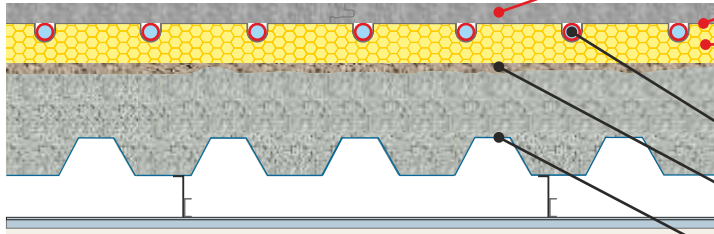

250 - 500kPa

**CELLECTA ScreedBoard 20**  
Highly conductive interlocking floorboard

**CELLECTA ULTRApate 0.5**  
Heat diffusion plate manufactured to suit pipe diameter

**CELLECTA XFLO 250/300/500**  
Routed UFH board manufactured to suit pipe diameter and centres

**CELLECTA YELOfon ES5** (not shown)  
(Thermal, acoustic and expansion gap strip installed around floor perimeter)

UFH plastic pipe (supplied by others)

Levelling screed applied to beam and block flooring to SR2 (min) standard

In-situ concrete slab supported by profiled steel decking (To structural engineers' specification)

## UFH Insulation Board



CELLECTA's **XFLO** boards are manufactured to suit the pipe diameter and spacing required to achieve the desired thermal output. The board's high compressive strength enables it to withstand the rigours of the installation process as well as the long term loads imposed in residential and commercial applications.

### Key Benefits

- High resistance to compression - 250, 300 & 500kPa
- Manufactured to suit pipe and spacing required
- Works in conjunction with acoustic treatments
- Outstanding thermal output

### Physical Properties

		XFLO		
		250	300	500
		High strength UFH board	High strength UFH board	Ultra strength UFH board
Strength at 10% compression	kPa	250	300	500
Thermal conductivity	W/mK	0.033	0.033 ≤80mm 0.034 >81mm	0.035
Temperature range	°C	-50/+75	-50/+75	-50/+75
Route sizes available (to suit pipe diameter)	mm	10, 12, 14, 15, 16, 18, 20	10, 12, 14, 15, 16, 18, 20	10, 12, 14, 15, 16, 18, 20
Pipe centres	mm	150, 200, 300	150, 200, 300	150, 200, 300
Board size	mm	600 x 2500	600 x 2500	600 x 1200* 600 x 1250
Thickness* (other sizes manufactured to order)	mm	20, 25, 30, 35	40, 50, 60, 75	15*, 18*, 50, 60, 75

## Overlay Board

### ScreedBoard® 20

Interlocking high conductivity overlay board

**Thickness:** 20mm

**Board size:** 600 x 1200mm

**Weight:** 25kg/m<sup>2</sup> / 18kg per sheet

**Thermal resistance:** 0.05m<sup>2</sup>k/W



### Heat Diffuser

### ULTRApate 0.5

High performance pressed aluminium diffuser plate

**Plate thickness:** 0.5mm

**Plate length:** 1000mm

**To suite pipe sizes:** 10, 12, 14, 15, 16, 20mm

### Perimeter Edge Strip

### YELOfon® ES5/120

Closed-cell extruded polyethylene edge strip

**Thickness:** 5mm x 120mm x 50m

## Accreditation & Approvals



## Environmental Credentials

