

Suspended ground floor - Solid timber joists

Underfloor heating pipe inserted into **CELLECTA XFLO Ultraboard** underfloor heating insulation board
 Floor finishes directly applied to UFH board
 Micro thin system

WU9.gtf2

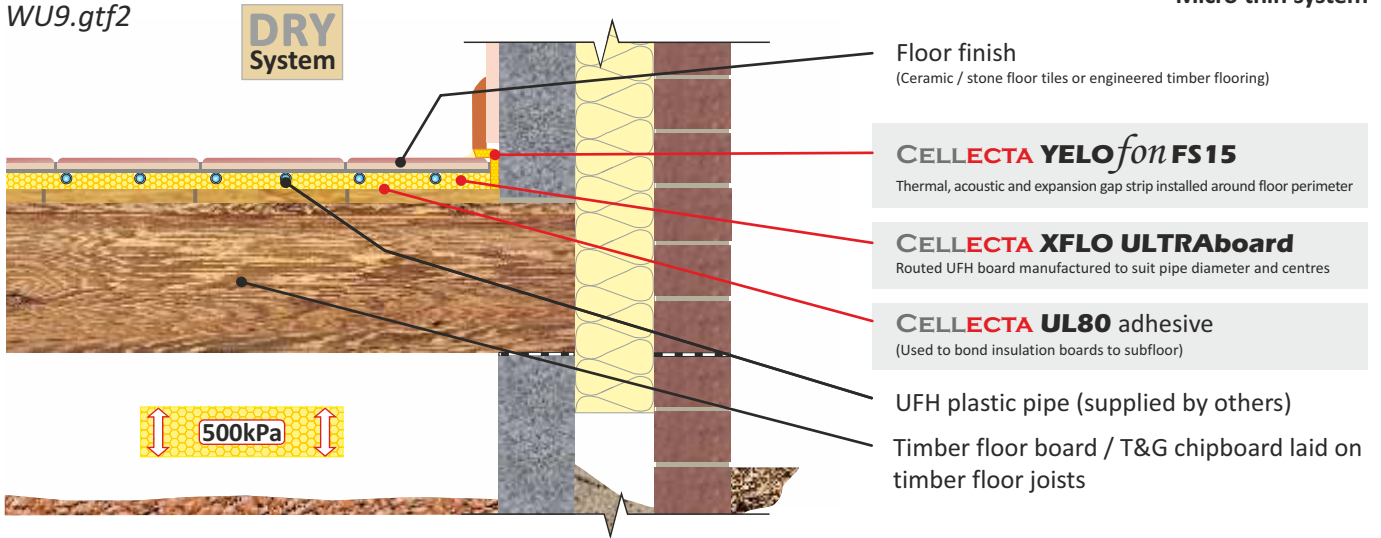

Floor finish
 (Ceramic / stone floor tiles or engineered timber flooring)

CELLECTA YELOfon FS15
 Thermal, acoustic and expansion gap strip installed around floor perimeter

CELLECTA XFLO ULTRAboard
 Routed UFH board manufactured to suit pipe diameter and centres

CELLECTA UL80 adhesive
 (Used to bond insulation boards to subfloor)

UFH plastic pipe (supplied by others)

Timber floor board / T&G chipboard laid on timber floor joists

Micro UFH Insulation Board

XFLO[®] ULTRAboard

XFLO Ultraboard is a routed under floor heating insulation board with a unique reinforcement facing that enables floor tiles to be directly adhered. The board's long term ultra high compressive strength enables it to withstand the rigours of both domestic and commercial flooring applications. Two thickness' are available to suit 10mm and 12mm diameter pipes.

Key Benefits

- Ultra high compressive strength - 500kPa
- Manufactured to suit pipe and centres required
- Glass reinforcement facing accepts tiles

Physical Properties

		XFLO ULTRAboard
		Ultra high compressive strength, glass reinforcement mesh faced UFH board
Strength at 10% compression EN 826	kPa	500
Thermal conductivity	W/mK	0.035
Temperature range	°C	-50/+75
Route sizes available (to suit pipe diameter)	mm	10, 12
Pipe centres	mm	100, 150
Board size	mm	600 x 1200
Thickness'	mm	15, 18

Third Party Accreditation and Approvals

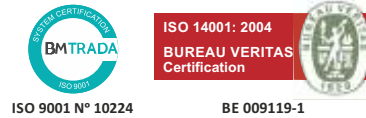

Environmental Credentials

