

Suspended ground floor - Beam and concrete block

Underfloor heating pipe inserted into **CELLECTA XFLO** underfloor heating insulation boards
CELLECTA ScreedBoard 20 laid over UFH boards
 Dry system

WU9.gf5 **DRY System**

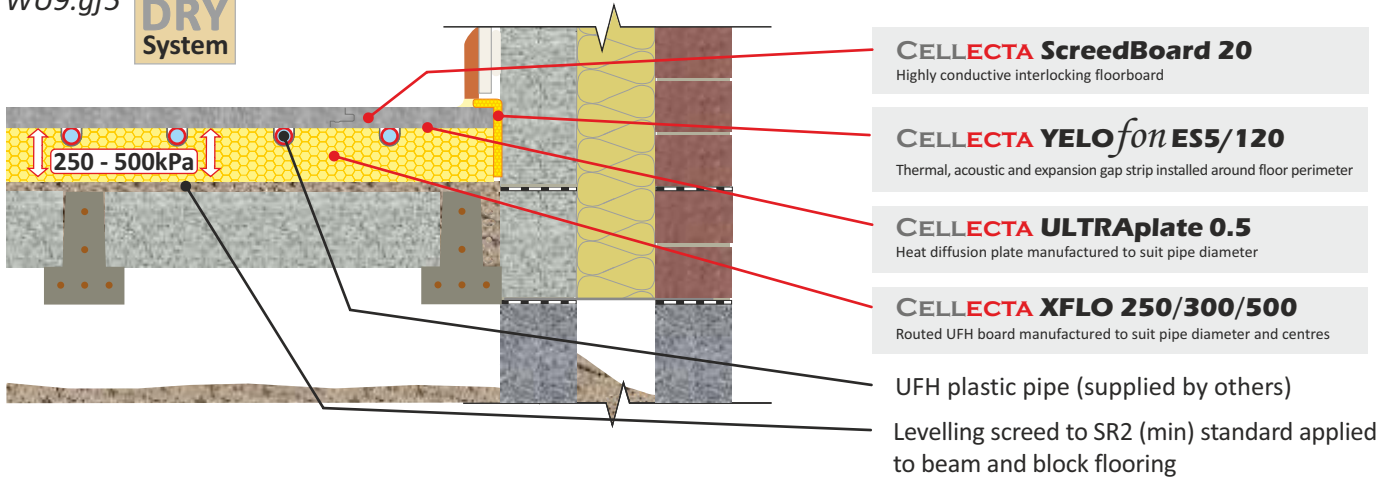

- CELLECTA ScreedBoard 20**
Highly conductive interlocking floorboard
- CELLECTA YELOfon ES5/120**
Thermal, acoustic and expansion gap strip installed around floor perimeter
- CELLECTA ULTRApate 0.5**
Heat diffusion plate manufactured to suit pipe diameter
- CELLECTA XFLO 250/300/500**
Routed UFH board manufactured to suit pipe diameter and centres

UFH plastic pipe (supplied by others)
 Levelling screed to SR2 (min) standard applied to beam and block flooring



UFH Insulation Board



CELLECTA's XFLO boards are manufactured to suit the pipe diameter and spacing required to achieve the desired thermal output. The board's high compressive strength enables it to withstand the rigours of the installation process as well as the long term loads imposed in residential and commercial applications.

Key Benefits

- High resistance to compression - 250, 300 & 500kPa
- Manufactured to suit pipe and spacing required
- Works in conjunction with acoustic treatments
- Outstanding thermal output

Physical Properties

		XFLO		
		250	300	500
		High strength UFH board	High strength UFH board	Ultra strength UFH board
Strength at 10% compression	kPa	250	300	500
Thermal conductivity	-	0.033	0.033 ≤80mm 0.034 >81mm	0.035
Temperature range	°C	-50/+75	-50/+75	-50/+75
Route sizes available (to suit pipe diameter)	mm	10, 12, 14, 15, 16, 18, 20	10, 12, 14, 15, 16, 18, 20	10, 12, 14, 15, 16, 18, 20
Pipe centres	mm	150, 200, 300	150, 200, 300	150, 200, 300
Board size	mm	600 x 2500	600 x 2500	600 x 1200* 600 x 1250
Thickness* (other sizes manufactured to order)	mm	20, 25, 30, 35	40, 50, 60, 75	15*, 18*, 50, 60, 75

Typical Thickness of UFH Insulation Required

P/A ratio	XFLO 300 (mm)							
0.7	75	100	120	130	150	180	220	270
0.6	70	90	100	130	150	175	210	270
0.5	70	90	100	120	140	170	210	260
0.4	60	80	100	110	130	160	200	250
0.3	50	70	80	100	120	160	190	240
	0.25	0.22	0.20	0.18	0.16	0.14	0.12	0.10

U-value (W/m²K)
 Calculated in accordance with ISO 13370

Accreditation & Approvals



Environmental Credentials



Overlay Board

ScreedBoard® 20

Interlocking high conductivity overlay board
Thickness: 20mm
Board size: 600 x 1200mm
Weight: 25kg/m² / 18kg per sheet
Thermal resistance: 0.05m²k/W



Heat Diffuser

ULTRApate 0.5

High performance pressed aluminium diffuser plate
Plate thickness: 0.5mm
Plate length: 1000m
To suite pipe sizes: 10, 12, 14, 15, 16, 20mm