

Separating floor - Metal web joists

Robust Detail E-FT-3

CELLECTA XFLO JB underfloor heating insulation boards installed between battens
CELLECTA HiDECK Structural 25/30 board laid on CELLECTA DECKfon Batten 70
Use with timber frame walls only

WU9.stf6

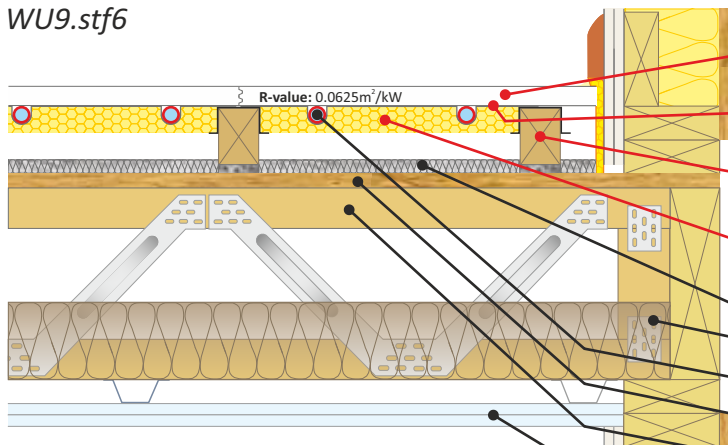

CELLECTA HiDECK Structural 25/30
Highly conductive interconnecting floorboard

CELLECTA ULTRAPlate 0.5
Aluminium heat diffuser plate manufactured to suit pipe diameter

CELLECTA DECKfon Batten 70
Resilient composite deep batten

CELLECTA XFLO JB
Routed UHF board manufactured to suit pipe diameter and centres

Sound absorption quilts (To RD specifications)

UHF plastic pipe supplied by others

18mm thick wood based board

235mm deep metal web joists
(To structural engineers' and RD specifications)

Ceiling treatment, inc. **CELLECTA HP30**
resilient bars: 30mm deep x 3000mm long

Typical Acoustic Performance

Airborne: 56dB $D_{nT,w} + C_{tr}$ rd $DR_w = 18dB$	Impact: 52dB $L_{nT,w}$ rd $DL_w = 16dB$	Building Regs 5dB
---	--	-----------------------------

UHF Insulation Board

XFLO JB

CELLECTA's XFLO JB boards are manufactured from 100% recyclable HEXATHERM, using a CNC to route out the pipe diameter and centres required. The board's are made to suit the specific batten spacing. When used in conjunction with CELLECTA's ULTRAPlates (heat diffuser plates) will provide outstanding heat output.

Key Benefits

- Manufactured to suit pipe and centres required
- Works in conjunction with heat diffusion plates
- Outstanding thermal output
- Supplied to suit batten spacing

Physical Properties

		XFLO JB		ULTRAPlate
		250	300	
		Between joist UHF board	Between joist UHF board	Aluminium heat diffuser plate
Strength at 10% compression	kPa	250	300	-
Thermal conductivity	W/mk	0.033	0.033	-
Temperature range	°C	-50/+75	-50/+75	-
Route sizes available (to suit pipe diameter)	mm	10, 12, 14, 15, 16, 18, 20	10, 12, 14, 15, 16, 18, 20	10, 12, 14, 15, 16, 18, 20
Pipe centres	mm	150, 200	150, 200	150, 200
Board / plate size	mm	300 x 1250/2500 350 x 1200		340/390 x 1000
Thickness' (other sizes manufactured to order)	mm	20, 25, 30, 35	40, 50	0.5

Structural Board

FFT1

HiDECK® Structural 25/30

High conductivity structural floorboard

Thickness': 25, 30mm

Board size: 600 x 1200mm

Weight: 25 - 31.25kg/m², 30 - 37.50kg/m²

Thermal resistance (m²k/W): 25 - 0.0625, 30 - 0.075

Heat Diffuser

ULTRAPlate 2C/0.5

High performance pressed aluminium diffuser plate

Number of channels: 2 Plate thickness: 0.5mm

Plate width: 340mm Plate length: 1000mm

To suite pipe sizes: 10, 12, 14, 15, 16, 20mm

Acoustic Batten

DECKfon® Batten 70

Composite deep batten system

Dimensions: 75mm x 45mm x 2400mm

Design height: 70mm (when floor loaded to 25kg/m²)

Sound Absorption Quilt (Non-itch Option)

FIBREfon® Micro 15 / 50

Polyester quilt

Dimensions:

15mm x 600mm x 1200mm, 50mm x 3/400mm x 7.2m

Accreditation & Approvals

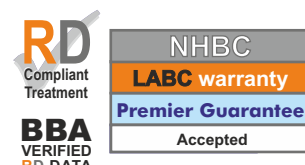

Environmental Credentials

