

CELLECTA **XFLO JB** underfloor heating insulation boards installed between battens

CELLECTA **HiDECK Structural** installed on CELLECTA **RUBBERfon Cradle** and batten system

System levels uneven structural floors

WU9.ssc3

**DRY  
System**

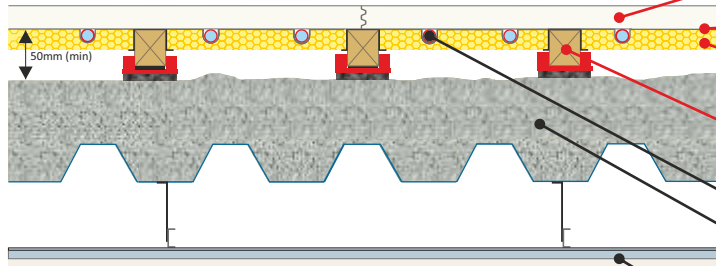

**CELLECTA HiDECK Structural 25, 30**  
Highly conductive interconnecting floorboard

**CELLECTA ULTRAplate** Aluminium heat diffuser plate manufactured to suit pipe diameter, centres and batten spacing

**CELLECTA XFLO JB** Routed UFH board manufactured to suit pipe diameter, centres and batten spacing

**CELLECTA RUBBERfon Cradles**  
Resilient acoustic cradle and timber batten system

UFH plastic pipe supplied by others

In-situ concrete slab supported by profiled steel decking, worse than SR2 standard  
(To structural engineers' and RD specification)

Ceiling treatment

## Typical Acoustic Performance

<b>Airborne:</b>	<b>54dB <math>D_{nT,w} + C_{tr}</math></b>	<b>Building Regulations</b> <b>+ 8dB</b>
<b>Impact:</b>	<b>44dB <math>L_{nT,w}</math> <math>rd\ DL_w = 25dB</math></b>	

## UFH Insulation Board

**XFLO<sup>®</sup> JB**

CELLECTA's **XFLO JB** boards are manufactured from 100% recyclable **HEXATHERM**, using a CNC to route out the pipe diameter and centres required. The board's are made to suit the specific batten spacing. When used in conjunction with CELLECTA's **ULTRAplates** (heat diffuser plates) will provide outstanding heat output.

## Key Benefits

- Manufactured to suit pipe and centres required
- Works in conjunction with heat diffusion plates
- Outstanding thermal output
- Supplied to suit batten spacing

## Physical Properties

		<b>XFLO JB</b>		
		<b>250</b>	<b>300</b>	<b>ULTRAplate</b>
		Between joist UFH board	Between joist UFH board	Aluminium heat diffuser plate
Strength at 10% compression	kPa	250	300	-
Thermal conductivity	W/mk	0.033	0.033	-
Temperature range	°C	-50/+75	-50/+75	-
Route sizes available (to suit pipe diameter)	mm	10, 12, 14, 15, 16, 18, 20	10, 12, 14, 15, 16, 18, 20	10, 12, 14, 15, 16, 18, 20
Pipe centres	mm	150, 200	150, 200	150, 200
Board / plate size	mm	300 x 1250/2500 350 x 1200		340/390 x 1000
Thickness' (other sizes manufactured to order)	mm	20, 25, 30, 35	40, 50	0.5

## Structural Board

**FFT2**

**HiDECK<sup>®</sup> Structural 25/30**

High conductivity structural floorboard

Thickness': 25, 30mm

Board size: 600 x 1200mm

Weight: 25 - 31.25kg/m<sup>2</sup>, 30 - 37.50kg/m<sup>2</sup>

Thermal resistance (m<sup>2</sup>k/W): 25 - 0.0625, 30 - 0.075

## Heat Diffuser

**ULTRAplate 2C/0.5**

High performance pressed aluminium diffuser plate

Number of channels: 2 Plate thickness: 0.5mm

Plate width: 340mm Plate length: 1000mm

To suite pipe sizes: 10, 12, 14, 15, 16, 20mm

## Acoustic Cradle and Batten Levelling System

**RUBBERfon<sup>®</sup> Cradles**

Resilient cradle system

Dimensions: 12mm x 100mm x 100mm

Packers: 2, 3, 5mm Elevation blocks: 20, 30, 40mm

## Perimeter Edge Strip

**YELOfon<sup>®</sup> ES5/120**

Closed-cell extruded polyethylene edge strip

Thickness: 5mm x 120mm x 50m

## Accreditation & Approvals



## Environmental Credentials



01634 29-66-77



collecta.co.uk



technical@collecta.co.uk