

# Intermediate floor - Metal C-section joists

Underfloor heating pipe inserted into **CELLECTA XFLO** underfloor heating insulation boards  
**CELLECTA ScreedBoard 20** laid over UFH boards  
 Dry system

WU9.isj1

**DRY**  
System

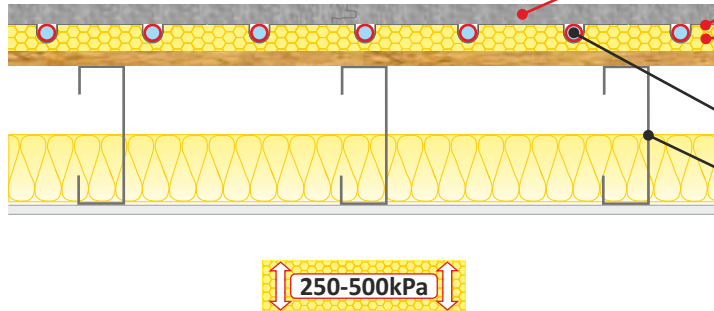

**CELLECTA ScreedBoard 20**  
Highly conductive interlocking floorboard

**CELLECTA ULTRAplate 0.5**  
Heat diffusion plate manufactured to suit pipe diameter

**CELLECTA XFLO 250/300/500**  
Routed UFH board manufactured to suit pipe diameter and centres

**CELLECTA YELOfon ES5** (not shown)  
(Thermal, acoustic and expansion gap strip installed around floor perimeter)

UFH plastic pipe (supplied by others)

Timber based board laid on metal C-section joists (To structural engineers' specification)

## UFH Insulation Board



CELLECTA's **XFLO** boards are manufactured to suit the pipe diameter and spacing required to achieve the desired thermal output. The board's high compressive strength enables it to withstand the rigours of the installation process as well as the long term loads imposed in residential and commercial applications.

### Key Benefits

- High resistance to compression - 250, 300 & 500kPa
- Manufactured to suit pipe and spacing required
- Works in conjunction with acoustic treatments
- Outstanding thermal output

### Physical Properties

		<b>XFLO</b>		
		<b>250</b>	<b>300</b>	<b>500</b>
		High strength UFH board	High strength UFH board	Ultra strength UFH board
Strength at 10% compression	kPa	250	300	500
Thermal conductivity	-	0.033	0.033 ≤80mm 0.034 >81mm	0.035
Temperature range	°C	-50/+75	-50/+75	-50/+75
Route sizes available (to suit pipe diameter)	mm	10, 12, 14, 15, 16, 18, 20	10, 12, 14, 15, 16, 18, 20	10, 12, 14, 15, 16, 18, 20
Pipe centres	mm	150, 200, 300	150, 200, 300	150, 200, 300
Board size	mm	600 x 2500	600 x 2500	600 x 1200* 600 x 1250
Thickness' (other sizes manufactured to order)	mm	20, 25, 30, 35	40, 50, 60, 75	15*, 18*, 50, 60, 75

## Overlay Board

### ScreedBoard® 20

Interlocking high conductivity overlay board

**Thickness:** 20mm

**Board size:** 600 x 1200mm

**Weight:** 25kg/m<sup>2</sup> / 18kg per sheet

**Thermal resistance:** 0.05m<sup>2</sup>k/W



### Heat Diffuser

### ULTRAplate 0.5

High performance pressed aluminium diffuser plate

**Plate thickness:** 0.5mm

**Plate length:** 1000mm

**To suite pipe sizes:** 10, 12, 14, 15, 16, 20mm

### Perimeter Edge Strip

### YELOfon® ES5/120

Closed-cell extruded polyethylene edge strip

**Thickness:** 5mm x 120mm x 50m

## Accreditation & Approvals



## Environmental Credentials



01634 29-66-77



collecta.co.uk



technical@collecta.co.uk