

# Intermediate floor - In-situ concrete slab

**CELLECTA HiDECK Structural** installed on **CELLECTA RUBBERfon Cradles** and batten system  
**CELLECTA XFLO JB** underfloor heating insulation boards installed between battens  
**System levels uneven structural floors**

WU9.ic3

**DRY  
System**

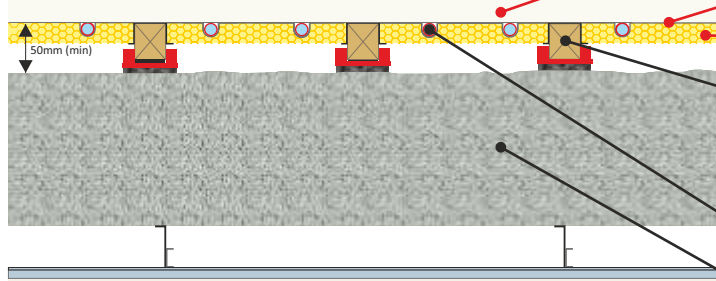

**CELLECTA HiDECK Structural 25, 30**  
 (Highly conductive interlocking floorboard)

**CELLECTA ULTRApate 2C** (Heat diffusion plate manufactured to suit pipe diameter, centres and batten spacing)

**CELLECTA XFLO JB** (Routed UHF board manufactured to suit pipe diameter, centres and batten spacing)

**CELLECTA RUBBERfon Cradles**  
 (Resilient acoustic cradle and timber battens)

**CELLECTA YELOfon ES5** (not shown)  
 (Thermal, acoustic and expansion gap strip installed around floor perimeter)

UFH plastic pipe (supplied by others)

In-situ concrete slab laid to worse than SR2 standard (To structural engineers' specification)

## UFH Insulation Board

**XFLO JB**

CELLECTA's XFLO JB boards are manufactured from 100% recyclable HEXATHERM, using a CNC to route out the pipe diameter and centres required. The board's are made to suit the specific batten spacing. When used in conjunction with CELLECTA's ULTRApates (heat diffuser plates) will provide outstanding heat output.

### Key Benefits

- Manufactured to suit pipe and centres required
- Works in conjunction with heat diffusion plates
- Outstanding thermal output
- Supplied to suit batten spacing

### Physical Properties

		XFLO JB		
		250	300	ULTRApate
		High strength UFH board	High strength UFH board	Aluminium heat diffuser plate
Strength at 10% compression	kPa	250	300	-
Thermal conductivity	W/mK	0.033	0.033	-
Temperature range	°C	-50/+75	-50/+75	-
Route sizes available (to suit pipe diameter)	mm	10, 12, 14, 15, 16, 18, 20	10, 12, 14, 15, 16, 18, 20	10, 12, 14, 15, 16, 18, 20
Pipe centres	mm	150, 200	150, 200	150, 200
Board / plate size	mm	300 x 1250/2500 350 x 1200		340/390 x 1000
Thickness' (other sizes manufactured to order)	mm	20, 25, 30, 35	40, 50	0.5

## Structural Board

### HiDECK® Structural 25/30

High conductivity structural floorboard

Thickness': 25, 30mm

Board size: 600 x 1200mm

Weight: 25 - 31.25kg/m², 30 - 37.50kg/m²

Thermal resistance (m²k/W): 25 - 0.0625, 30 - 0.075



### Heat Diffuser

### ULTRApate 2C/0.5

High performance pressed aluminium diffuser plate

Number of channels: 2 Plate thickness: 0.5mm

Plate width: 340mm Plate length: 1000mm

To suite pipe sizes: 10, 12, 14, 15, 16, 20mm

### Acoustic Cradle and Batten Levelling System

### RUBBERfon® Cradles

Resilient cradle system

Dimensions: 12mm x 100mm x 100mm

Packers: 2, 3, 5mm Elevation blocks: 20, 30, 40mm

### Perimeter Edge Strip

### YELOfon® ES5/120

Closed-cell extruded polyethylene edge strip

Thickness: 5mm x 120mm x 50m

## Accreditation & Approvals

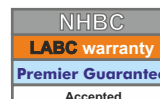

## Environmental Credentials



01634 29-66-77



collecta.co.uk



technical@collecta.co.uk