

Intermediate floor - In-situ concrete slab

CELLECTA HEXATHERM XFLOOR insulation installed below floating screed
Screed incorporating underfloor heating system

WU9.ic1

**DRY
System**

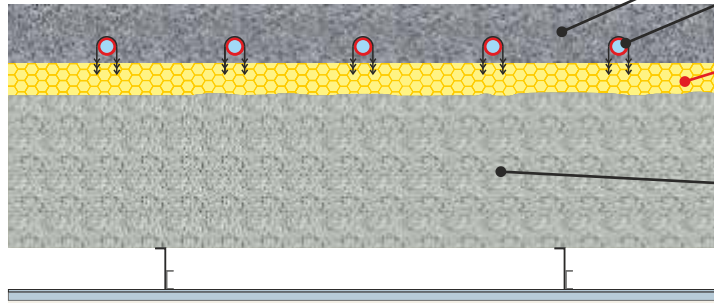

Sand/cement or anhydrite screed

Under floor heating pipes secured to insulation with proprietary clips

CELLECTA HEXATHERM XFLOOR 250 (Domestic/commercial applications)

CELLECTA HEXATHERM XFLOOR 300 (Domestic/commercial applications)

In-situ concrete slab laid to worse than SR2 standard (To structural engineers' specification)

250 - 300kPa

Insulation Board



XFLOOR 250/300

CELLECTA's XFLOOR 250/300 insulation boards have a high resistance to compression and closed cell structure that provides unrivalled resistance to water absorption, making them ideal for a multitude of domestic, commercial and educational applications.

Key Benefits

- ⬢ Twice the compressive strength of PiR
- ⬢ Excellent life-long thermal performance
- ⬢ Closed cell structure
- ⬢ Very low water absorption
- ⬢ 100% Recyclable

Physical Properties

		XFLOOR 250	XFLOOR 300
Thermal Conductivity EN 12667	W/mK	0.033	0.033 ≤80mm 0.034 >81mm
Strength at 10% compression EN 826	kPa	250	300
Strength at 2% compression EN 1606	kPa	80	125
Long term water absorption by immersion EN 12087	%	>0.7	>0.7
Board size	mm	600 x 2500	600 x 2500
Standard thickness' (other sizes manufactured to order)	mm	20, 25, 30	- - - 40, 50, 60, 75 80, 100, 120, 140, 160, 180, 200
Edge profile	-	 Square	 Square

Third Party Accreditation and Approvals



ISO 9001 N° 10224



Environmental Credentials



01634 29-66-77



collecta.co.uk



technical@collecta.co.uk