

WT9.s/1

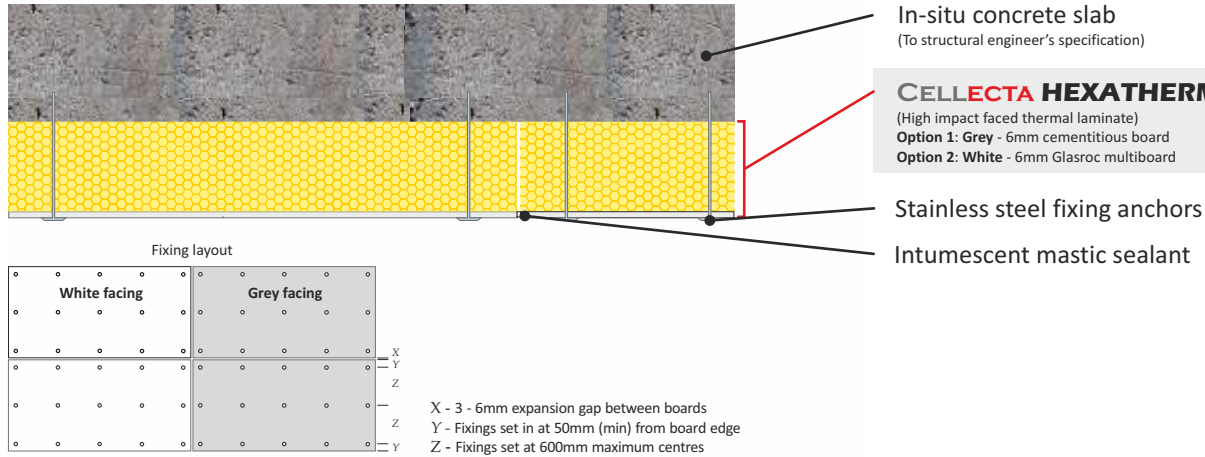

**FASTRACKCAD**  
ARCHITECTURAL CAD DATABASES

**ns5Plus**

**FASTRACKBIM**  
ARCHITECTURAL BIM DATABASES

## Product Information



CELLECTA's XCPL combines the benefits of a high performance **HEXATHERM** extruded polystyrene with a Class O, high impact facing board to produce an attractive composite thermal lining board, ideal for car park and soffit lining applications.

## Key Benefits

- Smooth high impact Class O facing
- Two colours available: White & grey
- Excellent life-long thermal performance
- Easy to install
- Very low water absorption

## Physical Properties

		<b>XCPL</b>
Thermal Conductivity EN 12667	W/mK	0.034
Strength at 10% compression EN 826	kPa	300
Temperature range	°C	-50/+75
Long term water absorption by immersion EN 12087	%	>0.7
Board size	mm	1200 x 2400
Thickness' available - including 6mm high impact Class O facing (other sizes manufactured to order)	mm	56, 66, 81, 86, 106, 126, 146, 166
Edge profile	-	Square

## Typical Thickness of Insulation Required

Thickness of concrete slab (mm)	<b>HEXATHERM® XCPL (mm)</b>				
<b>200</b>	120	140	160	170	190
<b>150</b>	120	140	160	170	190
	0.25	0.22	0.20	0.18	0.16
	U-value (W/m²K)				
	Calculated in accordance with ISO 13370				

## Third Party Accreditation and Approvals



## Environmental Credentials

