

CELLECTA HEXATHERM XFLOOR insulation installed below floating screed
Suspended in-situ concrete slab

WT9.sf1

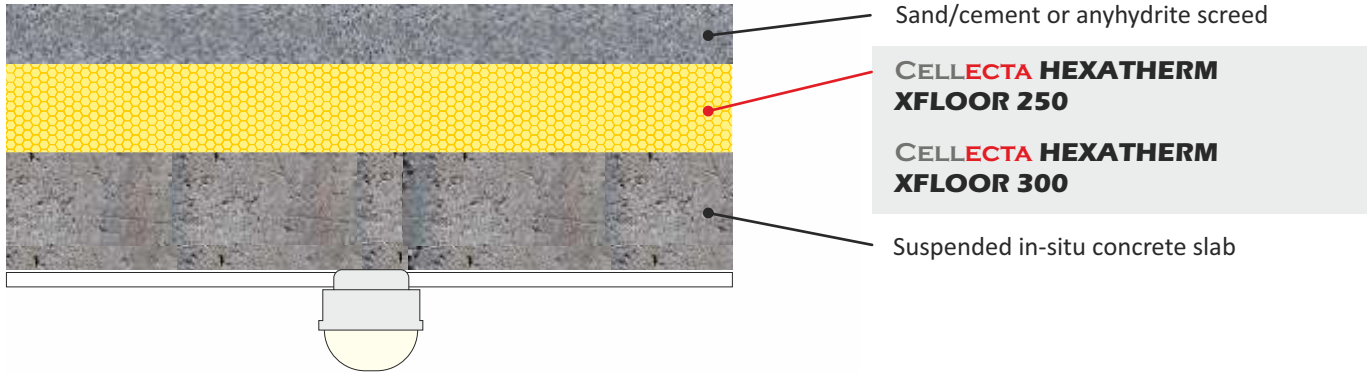

FASTRACK CAD
ARCHITECTURAL CAD DATABASES

n5Plus

FASTRACK BIM
ARCHITECTURAL BIM DATABASES

Product Information

XFLOOR 250/300

CELLECTA's XFLOOR 250/300 closed cell insulation boards have a high compressive strength and thermal performance, making them ideal for a multitude of suspended floor and soffit applications.

Key Benefits

- Twice the compressive strength of PiR
- Excellent life-long thermal performance
- Closed cell structure
- Very low water absorption
- 100% Recyclable

Physical Properties

		XFLOOR 250	XFLOOR 300
Thermal Conductivity EN 12667	W/mK	0.033	0.033 ≤40mm 0.034 >41mm
Strength at 10% compression EN 826	kPa	250	300
Strength at 2% compression EN 1606	kPa	80	125
Long term water absorption by immersion EN 12087	%	>0.7	>0.7
Board size	mm	600 x 2500	600 x 2500
Standard thickness' (other sizes manufactured to order)	mm	20, 25, 30	40, 50, 60, 75, 80, 100, 120, 140, 160, 180, 200
Edge profile	-	Square	Square

Typical Thickness of Insulation Required

Thickness of concrete slab (mm)	HEXATHERM XFLOOR 300 (mm)				
200	120	140	160	170	190
150	120	140	160	170	190
	0.25	0.22	0.20	0.18	0.16
	U-value (W/m²K)				
	Calculated in accordance with ISO 13370				

Third Party Accreditation and Approvals



ISO 9001 N° 10224



BE 009119-1



Environmental Credentials



01634 29-66-77



collecta.co.uk



technical@collecta.co.uk