

Construction details

TETRIS insulation components

Vertical Edge Strip (VES)
75mm (high) x 30mm x 2500mm

Gap Strip (TGS)
75mm x various widths x 2500mm

T Blocks: T600 / T300
90, 100, 120, 140, 160 x 600/300 x 2500mm

Concrete components

Pre-stressed concrete beams
150, 175 or 225mm high
x various lengths



Concrete blocks
100 x 440 x 215mm

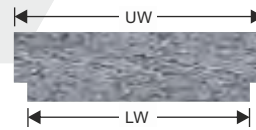

Concrete closer blocks
100 x 502 (UW) x 448(LW) x 138mm
100 x 202 (UW) x 148(LW) x 138mm

150mm Beam - Vertical edge detail

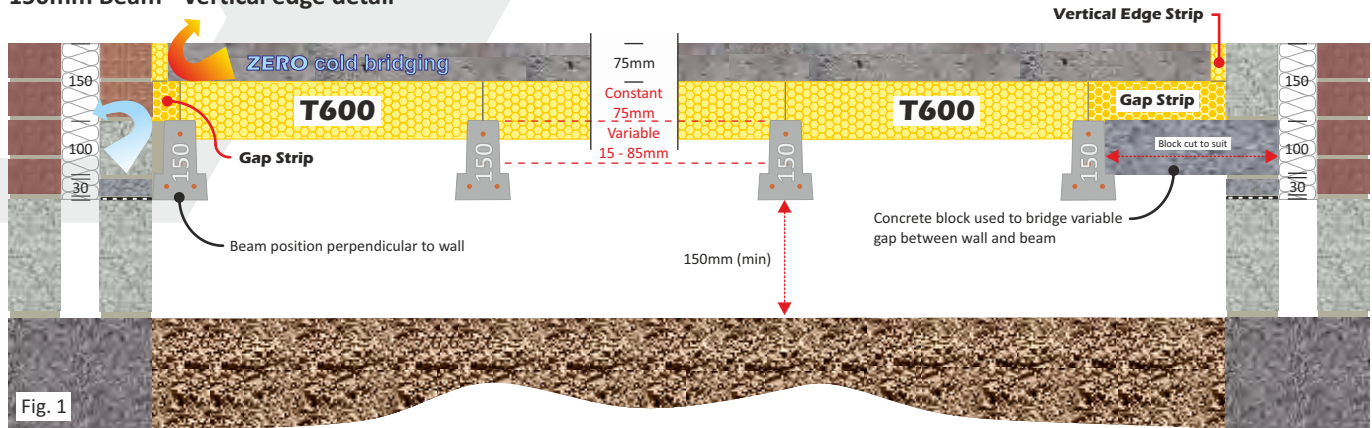

Fig. 1

175mm Beam - Vertical edge detail

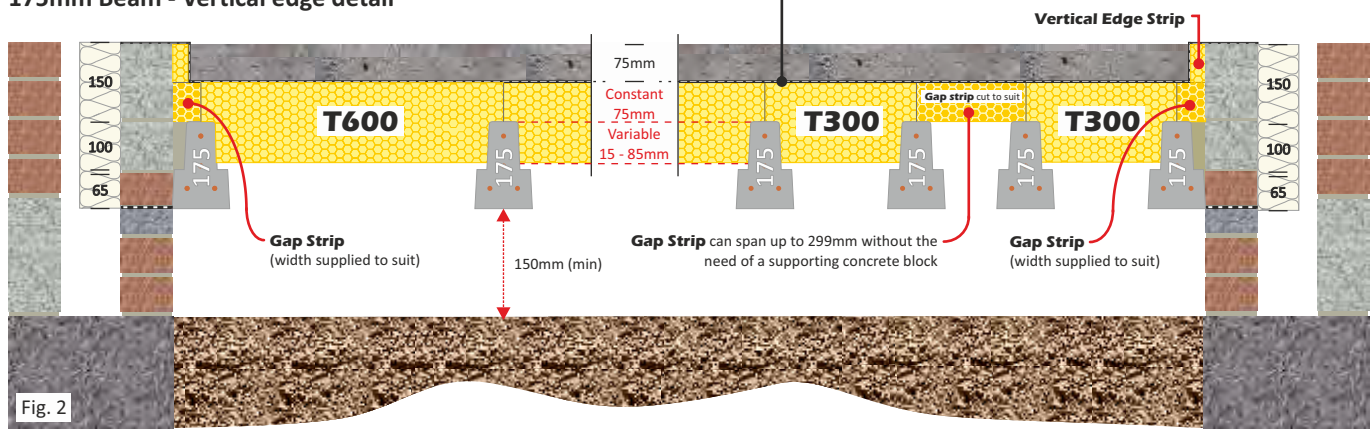

Fig. 2

150mm Beam - Vertical edge detail with additional layer of 75mm insulation

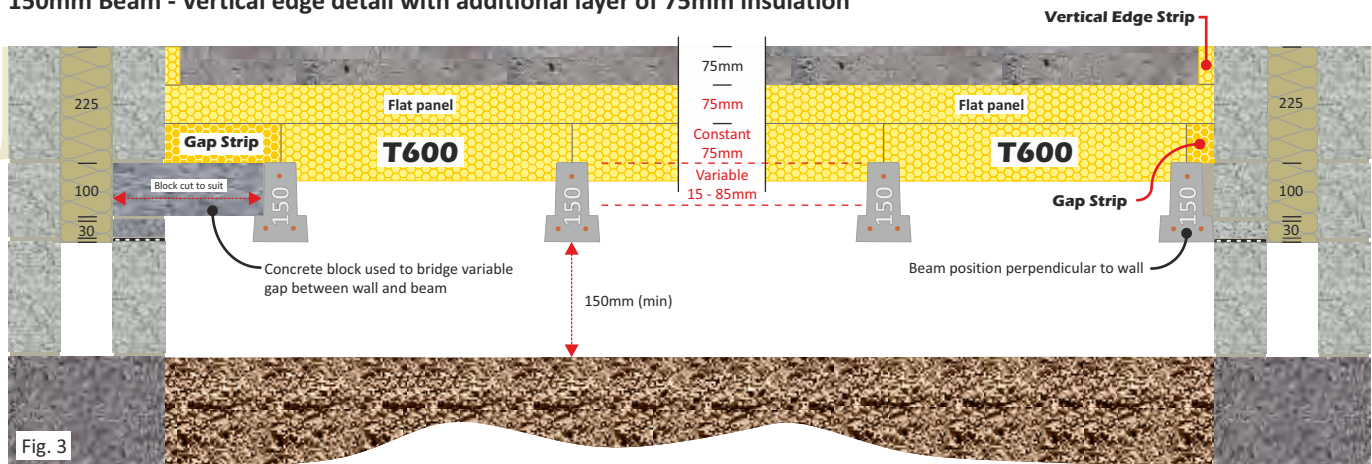
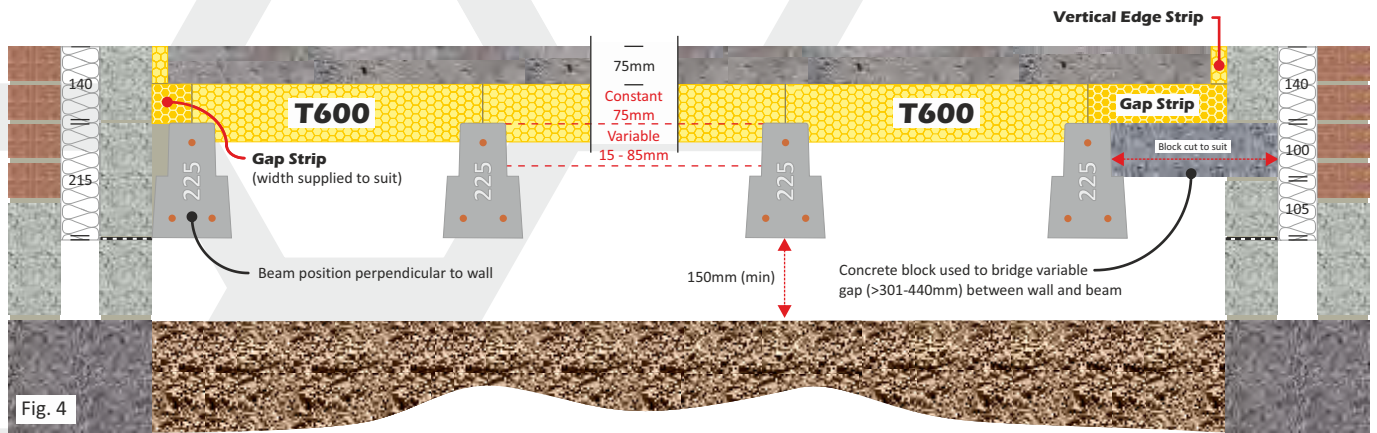

Fig. 3

Construction details

225mm Beam - Vertical edge detail



Vertical edge options - Timber frame buildings

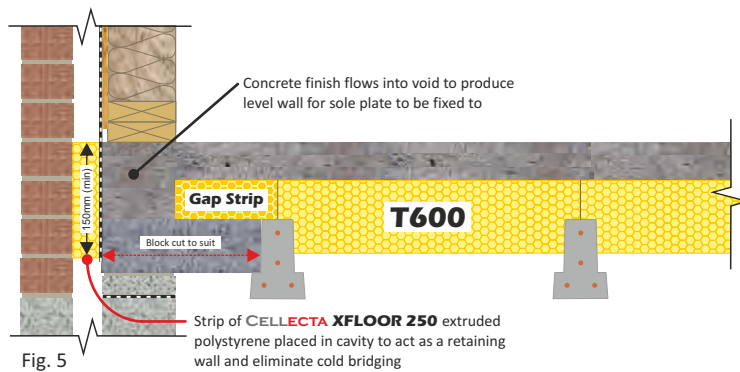

ON SITE?

Download the **FREE Collecta app** or watch the installation video on YouTube

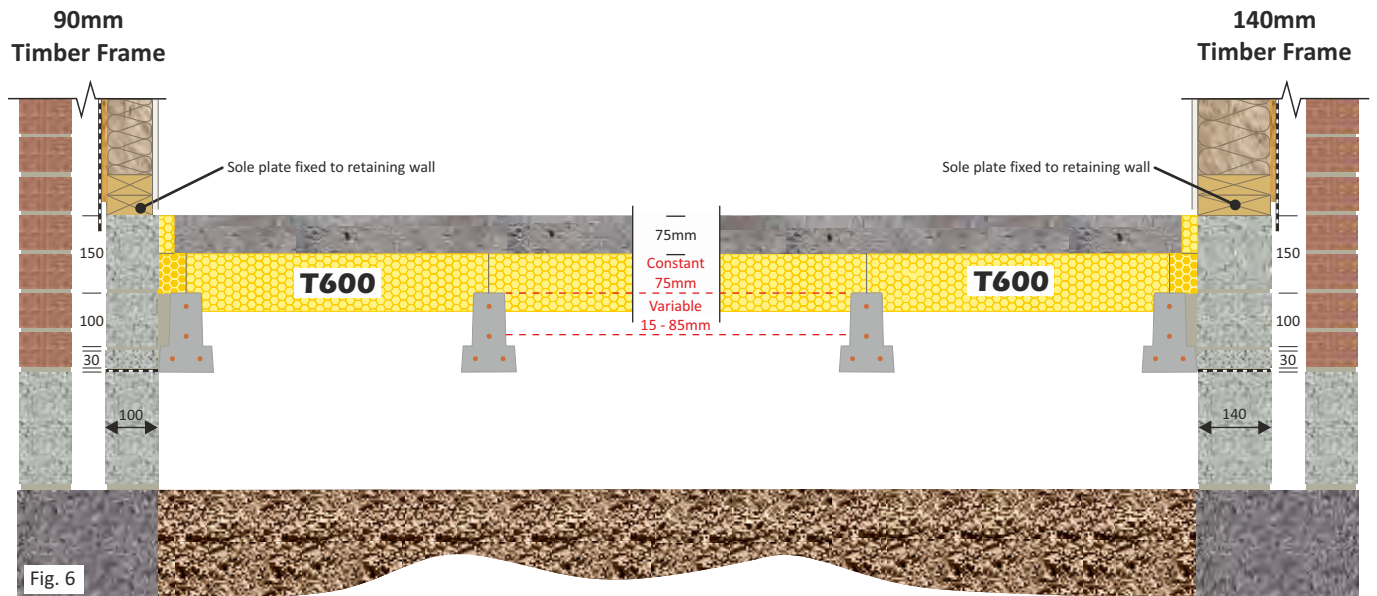

Double and triple beams

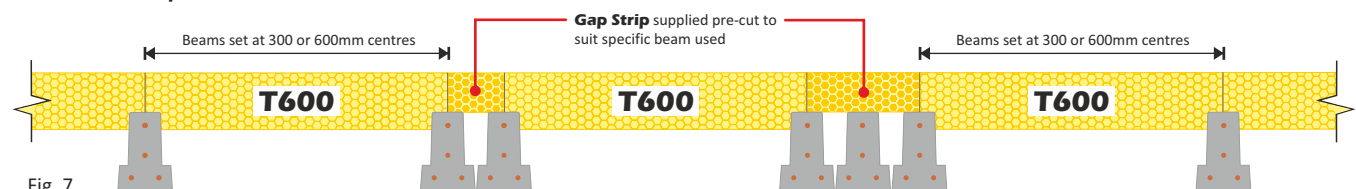

Construction details

Non-Load Bearing Partitions

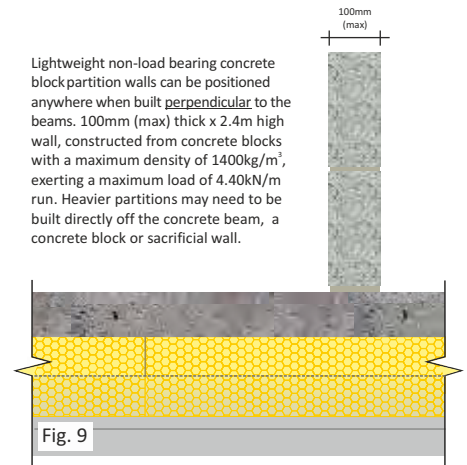
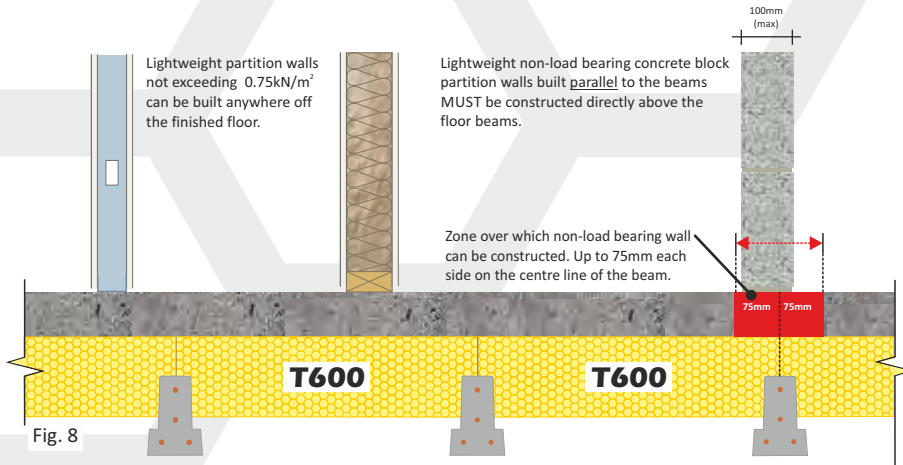

Load Bearing Partitions

Beams laid staggered on 100mm sleeper wall

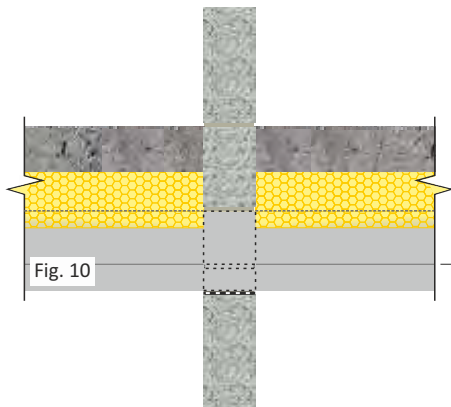

Beam ends butted on 200mm sleeper wall

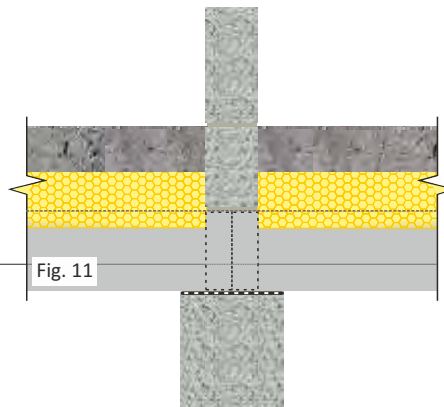

Underfloor Heating Systems (Supplied By Other)

An underfloor heating system can easily be integrated into the floor prior to applying the structural concrete floor finish.

Option 1

Secure the underfloor heating pipes to the TETRIS blocks with 'U' clips at the desired centres and cover with the structural concrete topping. Install the heating manifold at a later stage.

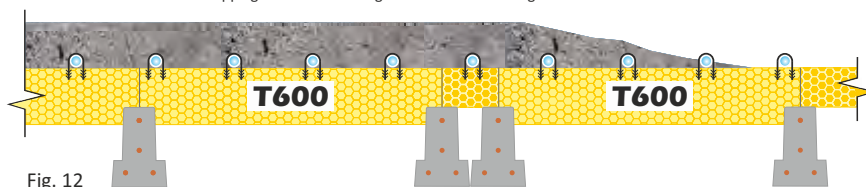

Option 2

Cover the TETRIS blocks with a D49 steel mesh. Cable-tie the underfloor heating pipes to the mesh at the desired centres and cover with the structural concrete. Install the heating manifold at a later stage.

