

## Insulation installed below floating screed

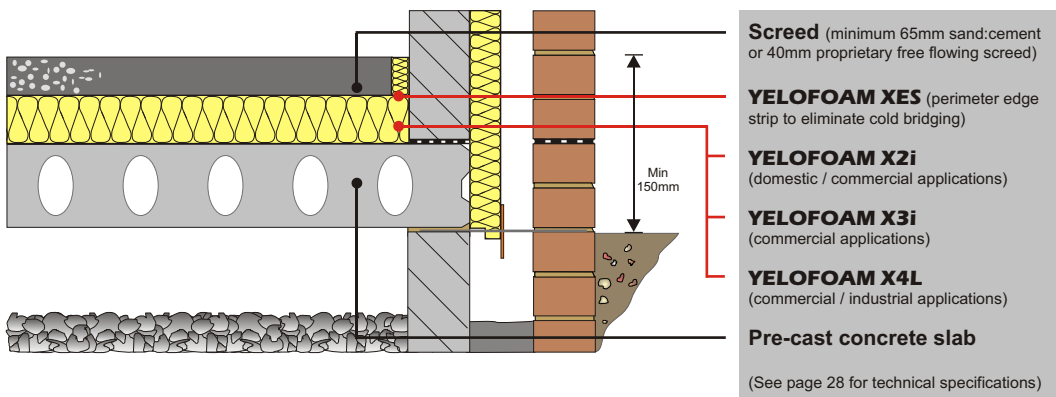

P/A ratio	Typical thickness of insulation req'd (mm)				
	0.7	75	90	100	120
0.6	70	90	100	120	140
0.5	65	80	100	120	140
0.4	60	75	90	100	120
0.3	50	65	80	100	120
	0.25	0.22	0.20	0.18	0.16

**U-value (W/m<sup>2</sup>K)**

Calculated in accordance with ISO 15370

Green Guide rating	<b>C</b>
Code points	<b>0.5</b>
Element N°	<b>20100012</b>

Green Guide Rating as interim document released by BRE in June 2007.

Fig. 10