

Soft floor covering fully bonded to structural concrete slab  
Suitable for Floor type 1<sup>(a)</sup> and Floor type 2<sup>(b)</sup>

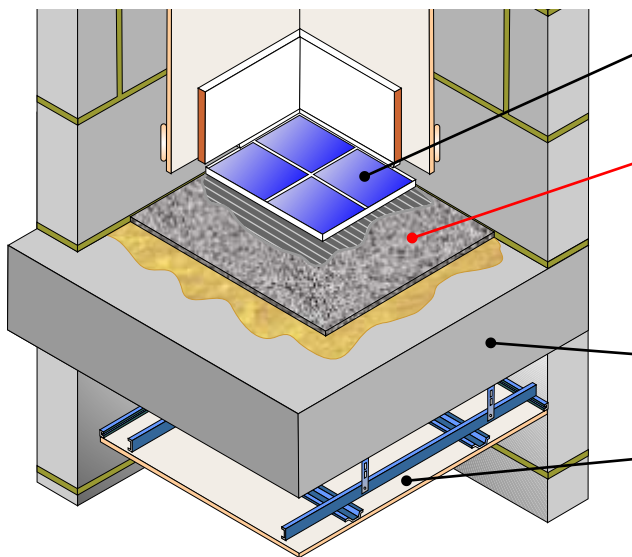

<b>Floor finish</b> (installed after acoustic testing)	Carpet Wooden flooring Ceramic tiles <sup>(c)</sup>
<b>Resilient layer</b>	DECKfon Ultralay 3/5 fully bonded to the concrete floor slab with <i>Collecta AF200</i> concrete adhesive DECKfon Ultralay 3SA/5SA stuck to concrete floor slab
<b>Structural floor</b>	<ul style="list-style-type: none"> <li>150mm (min) in-situ concrete floor, including any bonded screed with a mass per unit area of 300kg/m<sup>2</sup> (min)</li> </ul>
<b>Ceiling</b>	See <i>Table CF11</i> for ceiling treatment options

Fig. CF11 shows DECKfon Ultralay 3 covered with ceramic tiles



**FASTRACKCAD**<sup>®</sup>  
ARCHITECTURAL CAD DATABASES

Table CF11

PCT resilient layer installation options	Perimeter resilient flanking strip required	Ceiling treatment options
<p><b>DECKfon<sup>®</sup> Ultralay 3</b> <b>0 GWP</b> High density soft floor covering</p> <p><b>Typical PCT performance<sup>(a)</sup></b>  <math>R_w + C_{tr} = 58\text{dB}</math>  <math>L_{n,w} = 53\text{dB}</math>  <math>\Delta L_w = 22\text{dB}</math></p> <p><b>Code credits*</b>  <b>Pol 1</b> <b>Hea 2</b>  <b>1</b> <b>4</b></p> <p><b>Product information</b>                      3mm weight: 0.74kg/m<sup>2</sup>                      Product dimensions: see page 55  <i>Collecta AF200</i> concrete adhesive:                      15kg tub/ 22.5m<sup>2</sup> coverage</p> <p><i>Collecta AF200</i> concrete adhesive</p>	<p><b>No edge strip required</b></p>	<p><b>Any ceiling system including:</b></p> <p><b>Timber battens &amp; counter battens</b>                        100mm (min)</p> <p><b>Timber battens &amp; metal resilient bars</b>                        65mm (min)</p> <p><b>Metal frame ceiling systems</b>                        50mm (min)</p>
<p><b>DECKfon<sup>®</sup> Ultralay 5</b> <b>0 GWP</b> 100% recycled high density soft floor covering</p> <p><b>Typical PCT performance<sup>(a)</sup></b>  <math>R_w + C_{tr} = 58\text{dB}</math>  <math>L_{n,w} = 43\text{dB}</math>  <math>\Delta L_w = 31\text{dB}</math></p> <p><b>Code credits*</b>  <b>Pol 1</b> <b>Hea 2</b>  <b>1</b> <b>4</b></p> <p><b>Product information</b>                      5mm weight: 1.25kg/m<sup>2</sup>                      Product dimensions: see page 55  <i>Collecta AF200</i> concrete adhesive:                      15kg tub/ 22.5m<sup>2</sup> coverage</p> <p><i>Collecta AF200</i> concrete adhesive</p>	<p><b>No edge strip required</b></p>	<p><b>Any ceiling system including:</b></p> <p><b>Timber battens &amp; counter battens</b>                        100mm (min)</p> <p><b>Timber battens &amp; metal resilient bars</b>                        65mm (min)</p> <p><b>Metal frame ceiling systems</b>                        50mm (min)</p>

**Notes**  
<sup>(a)</sup> Floor type 1: Concrete base with ceiling and soft floor covering.  
<sup>(b)</sup> Suitable for improving the acoustic performance of Floor type 2: Concrete base with ceiling and floating layer.  
<sup>(c)</sup> Ceramic tile must be a minimum 150mm x 150mm (min).

\* Code for Sustainable Homes (CSH) credits quoted are typical. Mat 1 value taken from the BRE Green Guide. Pol 1 credit is only awarded if all the other insulation products used have a GWP of <5. Hea 2 credits are based on the floor being pre-completion tested and the separating wall performing to at least the same acoustic standard. Credits subject to relevant category weighted value. See page 5 for further information.

**Acoustic values**  
<sup>(a)</sup> Test data quoted has been conducted in a UKAS accredited laboratory in accordance with Approved Document E: Annex B: Procedures for sound insulation testing. Airborne results tested in accordance with BS EN ISO 140-3:1995 Impact results tested in accordance with BS EN ISO 140-6:1998  $\Delta L_w$  measured in accordance with BS EN ISO 140-8:1998 dB values quoted do not include the additional benefit of a ceiling treatment.