

In-situ concrete slab
Screed laid on resilient layers

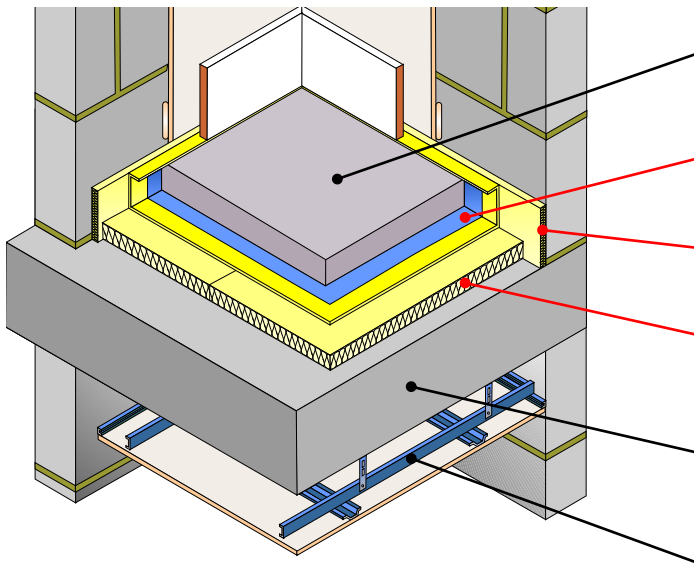

Screed	65mm (min) sand cement screed, or 40mm proprietary screed, nominal 80kg/m ² mass per unit area
Resilient layer (1)	5mm YELOfon HD5 extruded polyethylene (30kg/m ³)
Isolating edge strip	10mm YELOfon ES10/100 extruded polyethylene
Resilient layer (2)	25mm (min) YELOFOAM X2i extruded polystyrene insulation board. (See Table CF12 for full details)
Structural floor	<ul style="list-style-type: none"> • 150mm (min) in-situ concrete floor • 300kg/m² (min) mass per unit area
Ceiling	See Table CF12 for ceiling treatment options

Fig. CF12

IMPORTANT
If adopting this treatment, all three components **MUST** be installed:
1) YELOfon HD5 (resilient layer 1)
2) YELOFOAM X2i (resilient layer 2)
3) YELOfon ES10/100 (10mm isolation perimeter edge strip)



Table CF12

PCT resilient layers installation options		Perimeter resilient flanking strip required	Ceiling treatment options
<p>Resilient layer (1) YELOfon HD5 5mm extruded polyethylene (30kg/m³) GWP <5</p> <p>Resilient layer (2) YELOFOAM X2i High performance extruded polystyrene board GWP <5 Version available</p>	<p>Typical PCT performance ⁽²⁾</p> $D_{nT,w} + C_{tr} = 55\text{dB}$ $L_{nT,w} = 48\text{dB}$	<p>YELOfon ES10/100</p> <p>Polyethylene foam isolation strip: 10mm (t) x 100mm (h) x 50m (l) placed around the perimeter of the flooring board to isolate floor from walls and skirting.</p>	<p>Metal ceiling - 150mm void To be used with 150mm (min) depth concrete planks</p> <p>150mm (min)</p> <p>One layer of nominal 8kg/m² gypsum-based board</p> <p>Metal ceiling - 100mm void To be used with 200mm (min) depth concrete planks</p> <p>100mm (min)</p> <p>One layer of nominal 8kg/m² gypsum-based board</p> <p>Timber batten & counter battens ONLY to be used with 150mm (min) depth concrete planks</p> <p>100mm (min)</p> <p>One layer of nominal 8kg/m² gypsum-based board</p>
<p>Underfloor heating systems within screed</p>			
<p>Product dimensions HD5: 5mm (t) x 1.5m (w) x 75m (l) X2i: Refer to page 55</p>			
<p>Construction notes Materials must be installed in accordance with manufacturers' instructions to achieve stated acoustic values. Wall treatments MUST be isolated from the floating floor with YELOfon HD5 and ES10/100 flanking strip.</p>			

Code credits available

(Contact Collecta for further information)

Acoustic values

⁽²⁾ Values quoted are typical, based on the treatment being installed correctly and pre-completion tested. Airborne performance tested in accordance with BS EN ISO 140-4:1998. Impact performance tested in accordance with BS EN ISO 140-7:1998.