

In-situ concrete slab
Screed laid on YELOfon HD10+ resilient layer

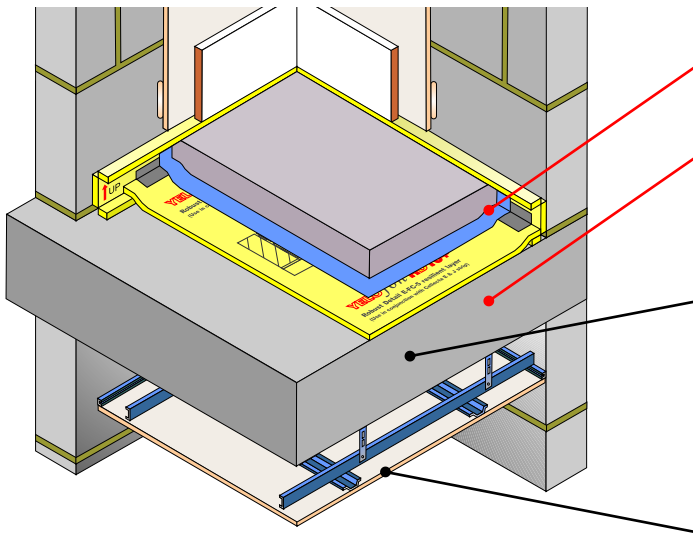

Screed	65mm (min) sand cement screed, or 40mm proprietary screed, nominal 80kg/m ² mass per unit area
Resilient layer	YELOfon HD10+ with E-strip perimeter edging and J-strip acoustic joining tape (See Table CF8 for full details)
Structural floor	<ul style="list-style-type: none"> • 250mm (min) in-situ concrete slab, 2400kg/m³ density without screed, or • 200mm (min) in-situ concrete slab 2400kg/m³ density with screed: 40mm sand & cement screed or 80kg/m² (min) proprietary screed directly applied to slab
Ceiling	See Table CF8 for ceiling treatment options

Fig. CF8



Table CF8

PCT resilient layer installation options	Perimeter resilient flanking strip required	Ceiling treatment options
<p>YELOfon HD10+ GWP <5</p> <p>10mm high density polyethylene foam with Surebond facing</p> <p>YELOfon J-strip GWP <5</p> <p>Acoustic joining tape</p> <p>Product dimensions HD10+: 10mm (t) x 1.5m (w) x 33.33m (l) E-Strip: 7mm (t) x 200mm (w) x 33m (l) J-strip: 2.5mm (t) x 75mm (w) x 33m (l) YELOFOAM X2i: Refer to page 55</p> <p>Typical PCT performance ⁽²⁾</p> <p>$D_{nT,w} + C_{tr} = 55\text{dB}$ $L_{nT,w} = 54\text{dB}$</p> <p>Underfloor heating systems within screed (with extra thermal insulation)</p> <p>YELOFOAM X2i GWP <5 Version available</p> <p>High performance extruded polystyrene board</p> <p>YELOfon HD10+ GWP <5</p> <p>10mm high density polyethylene foam with Surebond facing</p> <p>YELOfon J-strip GWP <5</p> <p>Acoustic joining tape</p> <p>Proprietary screeds</p> <p>If using a proprietary free flowing screed, HD10+ rolls can be tightly butted together and the joint sealed with J-strip. Care should be taken to ensure there are no gaps in the resilient layer. Cover the HD10+ with a 500 gauge (min) polythene sheet, taping all joints and lapping up around the perimeter by 150mm.</p>	<p>YELOfon E-strip</p> <p>Polyethylene foam flanking strip: 7mm (t) x 200mm (h) x 33m (l) with Surebond facing and self-adhesive backing, to suit 65mm - 100mm screeds, placed around the perimeter of the floor to isolate the screed from the walls and skirting. Seal all joints with J-strip.</p>	<p>Any metal ceiling system providing 100mm (min) ceiling</p> <p>100mm (min)</p> <p>One layer of nominal 8kg/m² gypsum-based board</p> <p>Timber battens & counter battens</p> <p>100mm (min)</p> <p>One layer of nominal 8kg/m² gypsum-based board</p> <p>Timber battens & metal resilient bars</p> <p>65mm (min)</p> <p>One layer of nominal 10kg/m² gypsum-based board</p>

Code credits available

(Contact Collecta for further information)

Acoustic values
⁽²⁾ Values quoted are typical, based on the treatment being installed correctly and pre-completion tested. Airborne performance tested in accordance with BS EN ISO 140-4:1998. Impact performance tested in accordance with BS EN ISO 140-7:1998.