

Existing timber joists  
Acoustic treatment laid on sub-floor

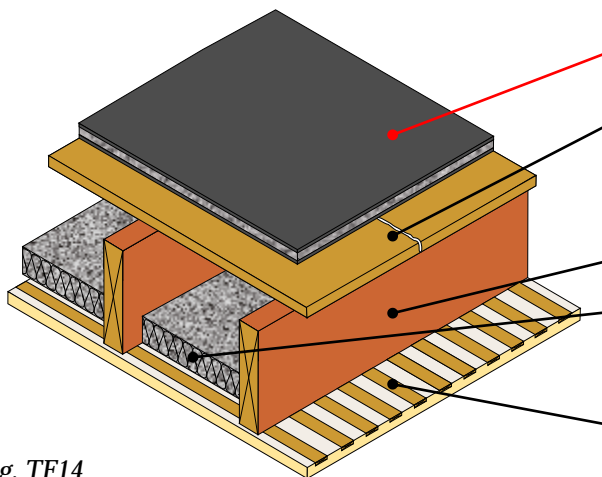

Fig. TF14

<b>Floating floor treatment</b>	DECK <i>fon</i> Ultramat 15 (See Table TF14 for full details)
<b>Floor decking</b>	18mm thick (min) wood based board, density 600kg/m <sup>3</sup> (min) or existing floor boards (with all gaps sealed with suitable flexible mastic)
<b>Joists</b>	Solid timber joists
<b>Absorbing material</b>	<ul style="list-style-type: none"> <li>• 50mm FIBRE <i>fon</i> MICRO SLAB 50</li> <li>• 100mm (min) mineral wool insulation (45kg/m<sup>3</sup>) between joists</li> </ul>
<b>Ceiling</b>	See Table TF14 for ceiling treatments



**FASTRACKCAD**  
ARCHITECTURAL CAD DATABASES

Table TF14

PCT floating floor treatment		Perimeter resilient flanking strip required	Ceiling treatment options
<p><b>DECK <i>fon</i> Ultramat 15</b> High density composite acoustic overlay mat</p> <p><b>Typical PCT performance<sup>(4)</sup></b>  <math>D_{nT,w} + C_{tr} = 45\text{dB}</math>  <math>L_{nT,w} = 59\text{dB}</math></p> <p><b>Product information</b>                      Mat dimensions: 15mm x 1000mm x 1200mm                      Edge profile: Square                      Weight: 15kg/m<sup>2</sup> / 18.00kg per mat</p>	<p><b>YELO <i>fon</i> ES5/15</b></p> <p>Polyethylene foam flanking strip: 5mm x 15mm x 50mm installed around the perimeter of the flooring board to isolate floor from walls and skirting.</p>	<p><b>Ceiling treatment</b> Plaster and lath ceiling with minimum mass of 16kg/m<sup>2</sup>, fixed directly to floor joists.</p>	
<p><b>DECK <i>fon</i> Ultramat 15</b> High density composite acoustic overlay mat</p> <p><b>Typical PCT performance<sup>(4)</sup></b>  <math>D_{nT,w} + C_{tr} = 50\text{dB}</math>  <math>L_{nT,w} = 55\text{dB}</math></p> <p><b>Product information</b>                      Mat dimensions: 15mm x 1000mm x 1200mm                      Edge profile: Square                      Weight: 15kg/m<sup>2</sup> / 18.00kg per mat</p>	<p><b>YELO <i>fon</i> ES5/15</b></p> <p>Polyethylene foam flanking strip: 5mm x 15mm x 50mm installed around the perimeter of the flooring board to isolate floor from walls and skirting.</p>	<p><b>Ceiling boards must not penetrate or touch the floor joists</b> 16mm (min) metal resilient bars mounted at right angles to the joist at 400mm centres.</p> <p><b>Ceiling treatment</b> Two layers of gypsum-based board, composed of 15mm (nominal 12.5kg/m<sup>2</sup>) fixed with 25mm screws and a second layer of 15mm (nominal 12.5kg/m<sup>2</sup>) fixed with 42mm screws, with all joists staggered.</p>	

**Construction notes**  
Materials must be installed in accordance with manufacturers' instructions to achieve stated acoustic values. Wall treatments **MUST** be isolated from the floor treatment with YELOfon ES5/15 flanking strip. Ensure services do not come into contact with the floor treatment.

**Acoustic values**  
<sup>(4)</sup> Values quoted are typical, based on the treatment being installed correctly, covered with a 9mm MDF board and pre-completion tested. Airborne performance tested in accordance with BS EN ISO 140-4:1998 Impact performance tested in accordance with BS EN ISO 140-7: 1998