

Structural separating floor - Timber (existing)

PCT solution

Existing timber joists
Acoustic treatment laid on sub-floor
Metal frame secondary ceiling

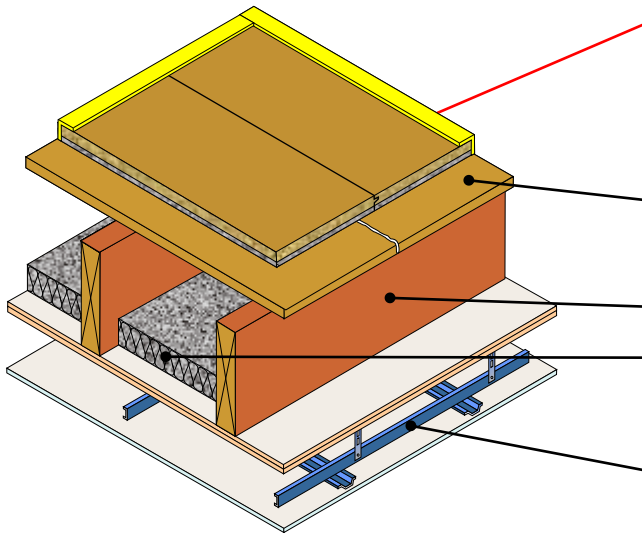

Floating floor treatment options	DECKfonMDF 17T DECKfonCHIP 26T DECKfonCHIP 30T (See Table TF15 for full details)
Floor decking	18mm thick (min) chipboard or existing floor boards (with all gaps sealed with suitable flexible mastic)
Joists	Solid timber joists
Absorbing material	<ul style="list-style-type: none"> • 50mm FIBRE fon MICRO SLAB 50 • 100mm (min) mineral wool insulation (45kg/m³) between joists
Ceiling	See Table TF15 for ceiling treatment

Fig. TF15 shows DECKfonMDF 17T and ES5/60 flanking strip
Table TF15



FASTRACKCAD
ARCHITECTURAL CAD DATABASES

PCT floating floor treatment options	Perimeter resilient flanking strip required	Ceiling treatment options
<p>DECKfonMDF 17T 0 GWP Composite acoustic overlay board</p> <p>Typical PCT performance⁽²⁾ $Rw + C_v = 51dB$ $L_{n,w} = 55dB$</p> <p>Product information Board dimensions: 17mm x 600mm x 2400mm Edge profile: Tongue and groove (MR MDF) Weight: 7.45kg/m² / 10.74kg per board</p>	<p>YELOfon ES5/60</p> <p>Polyethylene foam flanking strip: 5mm (t) x 60mm (h) x 50m (l) placed around the perimeter of the flooring board to isolate floor from walls and skirting.</p>	<p>Primary ceiling fixed directly to joists with metal frame ceiling system providing 100mm (min) ceiling void fixed to underside</p> <p>Primary ceiling: Gypsum-based boarded ceiling with a nominal weight of 16kg/m² directly fixed to the floor joists.</p> <p>Sacrificial ceiling: Metal ceiling system with a 100mm (min) void fixed to underside of primary ceiling. One layer of nominal 8kg/m² gypsum based board.</p>
<p>DECKfonCHIP 26T 0 GWP Composite acoustic overlay board</p> <p>Typical PCT performance⁽²⁾ $Rw + C_v = 52dB$ $L_{n,w} = 56dB$</p> <p>Product information Board dimensions: 26mm x 600mm x 2400mm Edge profile: Tongue and groove (P5 chipboard) Weight: 13.40kg/m² / 19.29kg per board</p>	<p>YELOfon FS30</p> <p>Pre-formed polyethylene foam flanking angle: 6mm (t) x 30mm (w) x 30mm (h) x 2m (l) placed around the perimeter of the flooring board to isolate floor from walls and skirting.</p>	<p>Construction note Services must not puncture ceiling linings (except cables, which should be sealed with flexible sealant).</p>
<p>DECKfonCHIP 30T 0 GWP Composite acoustic overlay board</p> <p>Typical PCT performance⁽²⁾ $Rw + C_v = 52dB$ $L_{n,w} = 55dB$</p> <p>Product information Board dimensions: 30mm x 600mm x 2400mm Edge profile: Tongue and groove (P5 chipboard) Weight: 16.20kg/m² / 23.32kg per board</p>	<p>YELOfon FS30</p> <p>Pre-formed polyethylene foam flanking angle: 6mm (t) x 30mm (w) x 30mm (h) x 2m (l) placed around the perimeter of the flooring board to isolate floor from walls and skirting.</p>	

Construction notes
Materials must be installed in accordance with manufacturers' instructions to achieve stated acoustic values. Wall treatments **MUST** be isolated from the floating floor with YELOfon flanking strip. Ensure services do not come into contact with the floor treatment. Once laid, MDF17T boards should be covered with the final floor finish as soon as possible to eliminate the risk of mechanical damage to the edge detail.

Acoustic values
⁽²⁾ Values quoted are typical, based on the treatment being installed correctly and pre-completion tested. Airborne performance tested in accordance with BS EN ISO 140-4:1998. Impact performance tested in accordance with BS EN ISO 140-7: 1998

Structural separating floor - Timber (existing)

PCT solution

Existing timber joists
Acoustic treatment laid on sub-floor
Existing ceiling upgraded with metal frame system

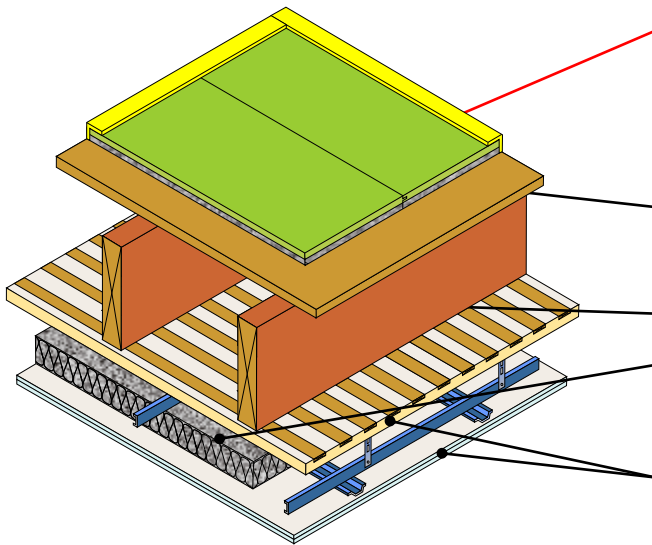

Floating floor treatment options	DECKfonMDF 17T DECKfonCHIP 26T DECKfonCHIP 30T (See Table TF15b for full details)
Floor decking	18mm thick (min) chipboard or existing floor boards (with all gaps sealed with suitable flexible mastic)
Joists	Solid timber joists
Absorbing material	<ul style="list-style-type: none"> • 50mm FIBREfon MICRO SLAB 50 • 100mm (min) mineral wool insulation (45kg/m³) between joists
Ceiling	See Table TF15b for ceiling treatment

Fig. TF15b shows DECKfonMDF 17T, ES5/60 flanking strip and FIBREfon MICRO SLAB 50

Table TF15b

PCT floating floor treatment options	Perimeter resilient flanking strip required	Ceiling treatment options
<p>DECKfonMDF 17T Composite acoustic overlay board</p> <p>Typical PCT performance⁽²⁾ $Rw + C_{tr} = 52dB$ $L_{n,w} = 54dB$</p> <p>Product information Board dimensions: 17mm x 600mm x 2400mm Edge profile: Tongue and groove (MR MDF) Weight: 7.45kg/m² / 10.74kg per board</p>	<p>YELOfon ES5/60</p> <p>Polyethylene foam flanking strip: 5mm (t) x 60mm (h) x 50m (l) placed around the perimeter of the flooring board to isolate floor from walls and skirting.</p>	<p>Primary ceiling fixed directly to joists with metal frame ceiling system providing 100mm (min) ceiling void fixed to underside</p> <p>Primary ceiling: Existing plaster and lath ceiling. Any holes filled with suitable material</p> <p>Sacrificial ceiling: Metal ceiling system with a 100mm (min) void fixed to underside of primary ceiling. Two layers of nominal 12.5kg/m² gypsum based board.</p>
<p>DECKfonCHIP 26T Composite acoustic overlay board</p> <p>Typical PCT performance⁽²⁾ $Rw + C_{tr} = 53dB$ $L_{n,w} = 55dB$</p> <p>Product information Board dimensions: 26mm x 600mm x 2400mm Edge profile: Tongue and groove (P5 chipboard) Weight: 13.40kg/m² / 19.29kg per board</p>	<p>YELOfon FS30</p> <p>Pre-formed polyethylene foam flanking angle: 6mm (t) x 30mm (w) x 30mm (h) x 2m (l) placed around the perimeter of the flooring board to isolate floor from walls and skirting.</p>	<p>Construction note Services must not puncture ceiling linings (except cables, which should be sealed with flexible sealant).</p>
<p>DECKfonCHIP 30T Composite acoustic overlay board</p> <p>Typical PCT performance⁽²⁾ $Rw + C_{tr} = 53dB$ $L_{n,w} = 54dB$</p> <p>Product information Board dimensions: 30mm x 600mm x 2400mm Edge profile: Tongue and groove (P5 chipboard) Weight: 16.20kg/m² / 23.32kg per board</p>	<p>YELOfon FS30</p> <p>Pre-formed polyethylene foam flanking angle: 6mm (t) x 30mm (w) x 30mm (h) x 2m (l) placed around the perimeter of the flooring board to isolate floor from walls and skirting.</p>	

Construction notes

Materials must be installed in accordance with manufacturers' instructions to achieve stated acoustic values. Wall treatments **MUST** be isolated from the floating floor with YELOfon flanking strip. Ensure services do not come into contact with the floor treatment. Once laid, MDF17T boards should be covered with the final floor finish as soon as possible to eliminate the risk of mechanical damage to the edge detail.

Acoustic values

⁽²⁾ Values quoted are typical, based on the treatment being installed correctly and pre-completion tested. Airborne performance tested in accordance with BS EN ISO 140-4:1998. Impact performance tested in accordance with BS EN ISO 140-7: 1998