

Timber I-joists, solid timber, metal web or timber web joists  
 Collecta ScreedBoard 20 laid on underfloor heating system  
 Use with timber frame walls only

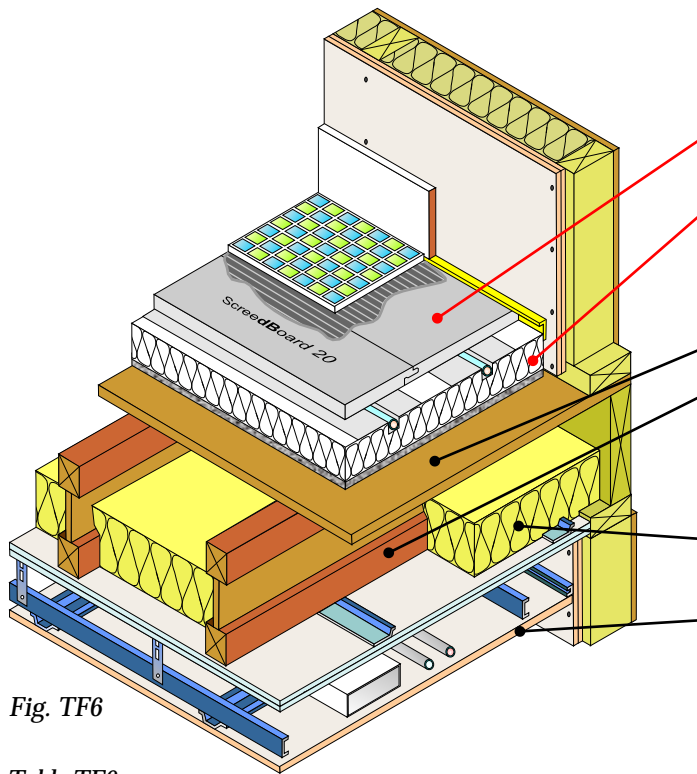

<b>Floor finish</b>	ScreedBoard 20 (See <i>Table TF6</i> for full details)
<b>Acoustic and thermal treatment</b>	Collecta factory produced acoustic / thermal laminate: 12mm (min) routed or moulded expanded or extruded polystyrene insulation bonded to MiCRO SLAB 8
<b>Floor decking</b>	15mm thick (min) OSB
<b>Joists</b>	<ul style="list-style-type: none"> <li>• 220mm (min) solid timber joist</li> <li>• 240mm (min) timber I-joists</li> <li>• 253mm (min) metal web joists</li> <li>• 254mm (min) timber web joists</li> </ul>
<b>Absorbing material</b>	100mm (min) quilt insulation (10-36g/m <sup>3</sup> ) between joists
<b>Ceiling</b>	See <i>Table TF6</i> for ceiling treatment

Fig. TF6

Table TF6



PCT floating floor treatment	Perimeter resilient flanking strip required	Ceiling treatment						
<p><b>ScreedBoard 20</b>                      Dry screed board with interlocking edges</p> <p><b>Underfloor heating thermal board with acoustic layer bonded to underside (option 1)</b>  <b>X2i / X2i<sup>e</sup></b>                      High performance extruded polystyrene boards</p> <p><b>(option 2)</b>                      Routed or moulded expanded polystyrene (EPS) panel</p> <p><b>&lt;5 GWP</b>                      All components*</p> <p><b>Additional layers required to complete treatment</b></p> <ul style="list-style-type: none"> <li>• Mineral wool quilt laid between joists - 100mm (min) 10-33kg/m<sup>3</sup></li> </ul> <p><b>Product information</b>  <b>ScreedBoard 20</b>                      Board dimensions: 20mm (t) x 600mm (w) x 1200mm (l)                      Edge profile: Interlocking tongue &amp; groove                      Weight: 25.00kg/m<sup>2</sup> / 18.00kg per board                      Thermal resistance: 0.20m<sup>2</sup>K/W                      Acoustic fleece: 8mm thick                      Collecta SB joint adhesive: 1L for every 33m<sup>2</sup> of boards</p> <p><b>X2i / X2i<sup>e</sup></b>: see page 55 for further information  <b>EPS</b>: refer to manufacturers technical data</p> <p><b>Construction notes</b>                      Materials must be installed in accordance with manufacturers' instructions to achieve stated acoustic values. Wall treatments <b>MUST</b> be isolated from the floating floor with YELOfon ES5/120 flanking strip. Ensure services do not bridge the resilient layer. Services must not puncture primary ceiling lining (except cables, which should be sealed with flexible sealant). ScreedBoards must be sealed with a suitable primer prior to ceramic tile being laid.</p>	<p><b>YELOfon FS50</b>                      Pre-formed polyethylene foam flanking angle: 6mm (t) x 50mm (w) x 30mm (h) x 2m (l) placed around the perimeter of the flooring board to isolate floor from walls and skirting.</p>	<p><b>Ceiling board fixings must not penetrate or touch the floor joists</b>                      16mm (min) metal resilient bars mounted at right angles to the joist at 400mm centres.</p> <p><b>Primary ceiling:</b>  <b>CT1</b>-Two layers of gypsum-based board, composed of 19mm (nominal 13.5kg/m<sup>2</sup>) fixed with 32mm screws and 12.5mm (nominal 10kg/m<sup>2</sup>) fixed with 42mm screws, with all joists staggered.  <b>CT2</b>-Two layers of gypsum-based board, composed of 15mm (nominal 12.5kg/m<sup>2</sup>) fixed with 25mm screws and a second layer of 15mm (nominal 12.5kg/m<sup>2</sup>) fixed with 42mm screws, with all joists staggered.</p> <p><b>Sacrificial ceiling (optional):</b>                      Metal ceiling system with a 100mm (min) void fixed to underside of primary ceiling. One layer of nominal 8kg/m<sup>2</sup> gypsum based board.</p>						
<p><b>Typical PCT performance</b><sup>(2)</sup></p> <p><math>D_{nT,w} + C_{tr} = 51\text{dB}</math></p> <p><math>L_{nT,w} = 55\text{dB}</math></p> <p><b>Code credits*</b></p> <table border="1"> <tr> <td>Mat 1</td> <td>Pol 1</td> <td>Hea 2</td> </tr> <tr> <td>2</td> <td>1</td> <td>3</td> </tr> </table>	Mat 1	Pol 1	Hea 2	2	1	3	<p>* Excluding X2i</p>	<p><b>Acoustic values</b>  <sup>(2)</sup> Values quoted are typical, based on the treatment being installed correctly and pre-completion tested. Airborne performance tested in accordance with BS EN ISO 140-4:1998 Impact performance tested in accordance with BS EN ISO 140-7: 1998</p>
Mat 1	Pol 1	Hea 2						
2	1	3						

\* Code for Sustainable Homes (CSH) credits quoted are typical. Mat 1 value taken from the BRE Green Guide. Pol 1 credit is only awarded if all the other insulation products used have a GWP of <5. Hea 2 credits are based on the floor being pre-completion tested and the separating wall performing to at least the same acoustic standard. Credits subject to relevant category weighted value. See page 5 for further information.