

Structural separating floor - Timber (existing)

PCT solution

Existing timber joists
Acoustic treatment laid directly on floor joists
Ceiling fixed directly to joists

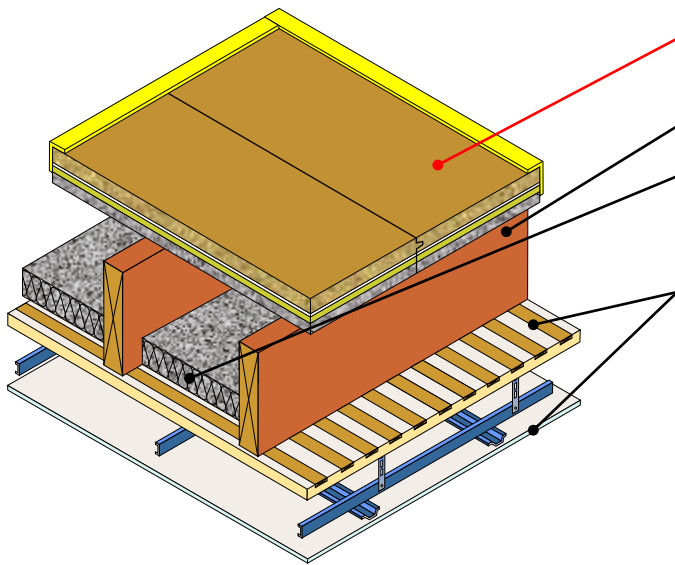

- Structural floating floor treatment** DECKfon Quattro (See Table TF11c for full details)
- Joists** Solid timber joists
- Absorbing material**
 - 50mm FIBRE fon MICRO SLAB 50
 - 100mm (min) mineral wool insulation (45kg/m³) between joists
- Ceiling** See Table TF11c for ceiling treatment



FASTRACKCAD
ARCHITECTURAL CAD DATABASES

Fig. TF11c

Table TF11c

PCT floating floor treatment	Perimeter resilient flanking strip required	Ceiling treatment options
<p>DECKfon Quattro <small>Composite acoustic structural overlay board</small></p> <p>Typical PCT performance⁽¹⁾</p> <p>$R_w + C_{tr} = 49\text{dB}$ $L_{n,w} = 58\text{dB}$</p> <p>Product information Board dimensions: 45mm (t) x 600mm (w) x 2400mm (l) Edge profile: Tongue & groove Weight: 20.00kg/m² / 28.88kg per board</p>	<p>YELOfon ES5/120</p> <p>Polyethylene foam flanking strip: 5mm (t) x 120mm (h) x 50m (l) placed around the perimeter of the flooring board to isolate floor from walls and skirting.</p>	<p>Ceiling treatment Plaster and lath ceiling with minimum mass of 16kg/m², fixed directly to floor joists.</p> <p>100mm (min) Service void</p>
<p>DECKfon Quattro <small>Composite acoustic structural overlay board</small></p> <p>Typical PCT performance⁽²⁾</p> <p>$R_w + C_{tr} = 54\text{dB}$ $L_{n,w} = 48\text{dB}$</p> <p>Product information Board dimensions: 45mm (t) x 600mm (w) x 2400mm (l) Edge profile: Tongue & groove Weight: 20.00kg/m² / 28.88kg per board</p> <p>Construction notes Materials must be installed in accordance with manufacturers' instructions to achieve stated acoustic values. Wall treatments MUST be isolated from the floating floor with YELOfon ES5/120 flanking strip. Ensure services do not come into contact with the floor treatment. Services must not puncture ceiling linings (except cables, which should be sealed with flexible sealant).</p>	<p>YELOfon ES5/120</p> <p>Polyethylene foam flanking strip: 5mm (t) x 120mm (h) x 50m (l) placed around the perimeter of the flooring board to isolate floor from walls and skirting.</p>	<p>Construction note Services must not puncture ceiling linings (except cables, which should be sealed with flexible sealant).</p>

Acoustic values

⁽¹⁾ Test data quoted was conducted in a UKAS accredited laboratory in accordance with Approved Document E: Annex B: Procedures for sound insulation testing. Airborne results tested in accordance with BS EN ISO 140-3:1995 Impact results tested in accordance with BS EN ISO 140-6: 1998