

# Structural separating floor - Timber (existing)

# PCT solution

Existing timber joists  
Acoustic treatment laid directly on floor joists  
Ceiling on resilient bars

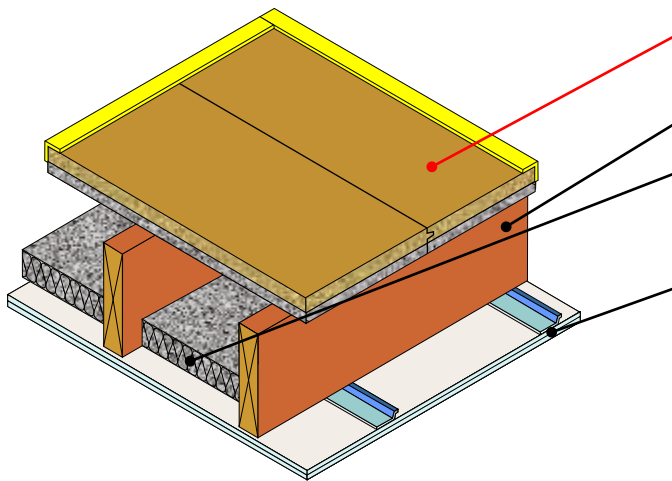

|  |   |
|--|---|
| <b>Structural floating floor treatment</b> | DECKfon CHIP 37T<br>(See Table TF12 for full details)   |
| <b>Joists</b>                              | Solid timber joists   |
| <b>Absorbing material</b>                  | <ul style="list-style-type: none"> <li>• 50mm FIBRE fon MICRO SLAB 50</li> <li>• 100mm (min) mineral wool insulation (45kg/m<sup>3</sup>) between joists</li> </ul> |
| <b>Ceiling</b>                             | See Table TF12 for ceiling treatment  |



**FASTRACKCAD**  
ARCHITECTURAL CAD DATABASES

Fig. TF12

Table TF12

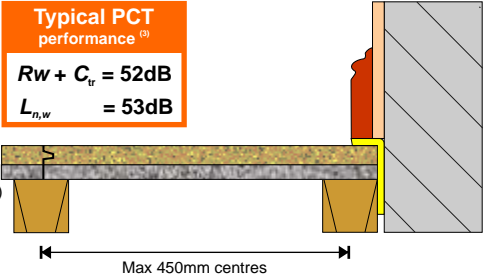
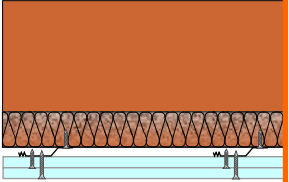
| PCT floating floor treatment  | Perimeter resilient flanking strip required  | Ceiling treatment options   |
|---|--|---|
| <p><b>DECKfon CHIP 37T</b><br/>Composite acoustic structural overlay board</p> <p><b>Typical PCT performance</b><sup>(3)</sup><br/> <math>Rw + C_{tr} = 52\text{dB}</math><br/> <math>L_{n,w} = 53\text{dB}</math></p> <p><b>Product information</b><br/>                     Board dimensions: 37mm (t) x 600mm (w) x 2400mm (l)<br/>                     Edge profile: Tongue &amp; groove<br/>                     Weight: 17.20kg/m<sup>2</sup> / 24.76kg per board</p>  <p><b>Construction notes</b><br/>                     Materials must be installed in accordance with manufacturers' instructions to achieve stated acoustic values. Wall treatments <b>MUST</b> be isolated from the floating floor with YELOfon ES5/100 flanking strip. Ensure services do not come into contact with the floor treatment.</p> | <p><b>YELOfon ES5/100</b></p> <p>Polyethylene foam flanking strip: 5mm (t) x 100mm (h) x 50m (l) placed around the perimeter of the flooring board to isolate floor from walls and skirting.</p> | <p><b>Ceiling boards must not penetrate or touch the floor joists</b><br/>                     16mm (min) metal resilient bars mounted at right angles to the joist at 400mm centres.</p> <p><b>Ceiling treatment</b><br/>                     Two layers of gypsum-based board, composed of 15mm (nominal 12.5kg/m<sup>2</sup>) fixed with 25mm screws and a second layer of 15mm (nominal 12.5kg/m<sup>2</sup>) fixed with 42mm screws, with all joists staggered.</p>  <p><b>Construction note</b><br/>                     Services must not puncture ceiling linings (except cables, which should be sealed with flexible sealant).</p> |

**Acoustic values**  
<sup>(3)</sup> Test data quoted was conducted in a UKAS accredited laboratory in accordance with Approved Document E: Annex B: Procedures for sound insulation testing.  
 Airborne results tested in accordance with BS EN ISO 140-3:1995  
 Impact results tested in accordance with BS EN ISO 140-6: 1998