

# Structural separating floor - Timber (existing)

# PCT solution

Existing timber joists  
Acoustic treatment laid directly on floor joists  
Ceiling fixed directly to joists

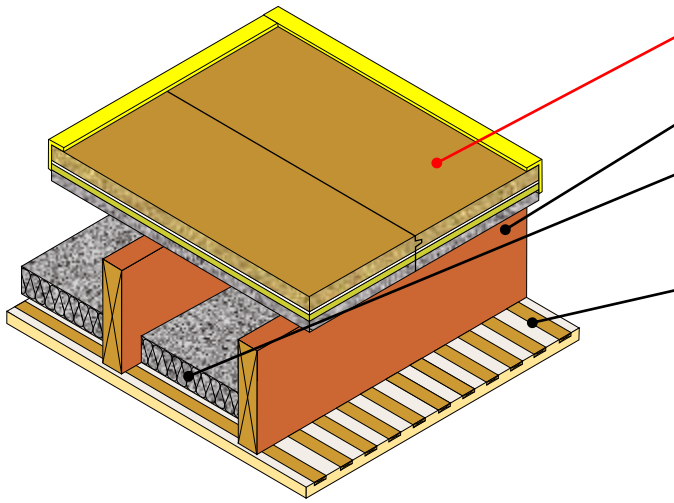

- Structural floating floor treatment** DECKfon Quattro (See Table TF11 for full details)
- Joists** Solid timber joists
- Absorbing material**
  - 50mm FIBRE fon MICRO SLAB 50
  - 100mm (min) mineral wool insulation (45kg/m<sup>3</sup>) between joists
- Ceiling** See Table TF11 for ceiling treatment options



**FASTRACKCAD**  
ARCHITECTURAL CAD DATABASES

Fig. TF11

Table TF11

PCT floating floor treatment	Perimeter resilient flanking strip required	Ceiling treatment options
<p><b>DECKfon Quattro</b> <b>GWP</b></p> <p>Composite acoustic structural overlay board</p> <p><b>Typical PCT performance</b><sup>(1)</sup></p> <p><math>Rw + C_{tr} = 49dB</math> <math>L_{n,w} = 58dB</math></p> <p><b>Product information</b> Board dimensions: 45mm (t) x 600mm (w) x 2400mm (l) Edge profile: Tongue &amp; groove Weight: 20.00kg/m<sup>2</sup> / 28.88kg per board</p>	<p><b>YELOfon ES5/120</b></p> <p>Polyethylene foam flanking strip: 5mm (t) x 120mm (h) x 50m (l) placed around the perimeter of the flooring board to isolate floor from walls and skirting.</p>	<p><b>Ceiling treatment</b> Plaster and lath ceiling with minimum mass of 16kg/m<sup>2</sup>, fixed directly to floor joists.</p>
<p><b>DECKfon Quattro</b> <b>GWP</b></p> <p>Composite acoustic structural overlay board</p> <p><b>Typical PCT performance</b><sup>(2)</sup></p> <p><math>Rw + C_{tr} = 54dB</math> <math>L_{n,w} = 48dB</math></p> <p><b>Product information</b> Board dimensions: 45mm (t) x 600mm (w) x 2400mm (l) Edge profile: Tongue &amp; groove Weight: 20.00kg/m<sup>2</sup> / 28.88kg per board</p> <p><b>Construction notes</b> Materials must be installed in accordance with manufacturers' instructions to achieve stated acoustic values. Wall treatments <b>MUST</b> be isolated from the floating floor with YELOfon ES5/120 flanking strip. Ensure services do not come into contact with the floor treatment. Services must not puncture ceiling linings (except cables, which should be sealed with flexible sealant).</p>	<p><b>YELOfon ES5/120</b></p> <p>Polyethylene foam flanking strip: 5mm (t) x 120mm (h) x 50m (l) placed around the perimeter of the flooring board to isolate floor from walls and skirting.</p>	<p><b>Ceiling boards must not penetrate or touch the floor joists</b> 16mm (min) metal resilient bars mounted at right angles to the joist at 400mm centres.</p> <p><b>Ceiling treatment</b> Two layers of gypsum-based board, composed of 15mm (nominal 12.5kg/m<sup>2</sup>) fixed with 25mm screws and a second layer of 15mm (nominal 12.5kg/m<sup>2</sup>) fixed with 42mm screws, with all joists staggered.</p>

**Acoustic values**

<sup>(1)</sup> Test data quoted was conducted in a UKAS accredited laboratory in accordance with Approved Document E: Annex B: Procedures for sound insulation testing. Airborne results tested in accordance with BS EN ISO 140-3:1995 Impact results tested in accordance with BS EN ISO 140-6: 1998

# Structural separating floor - Timber (existing)

# PCT solution

Existing timber joists  
Acoustic treatment laid directly on floor joists  
Ceiling fixed directly to joists

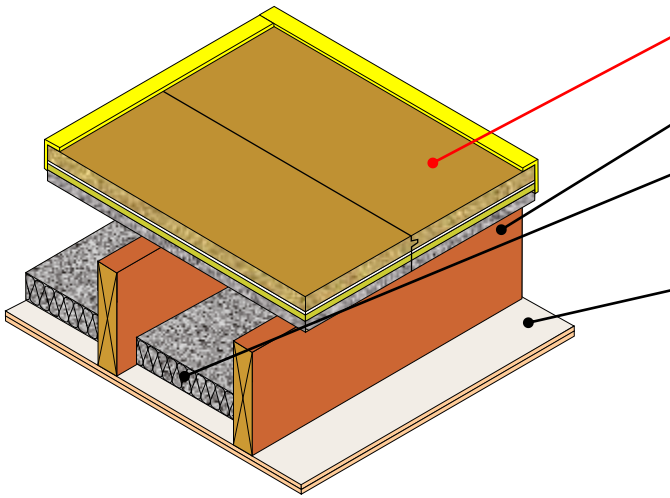



- Structural floating floor treatment** DECKfon Quattro (See Table TF11b for full details)
- Joists** Solid timber joists
- Absorbing material**
  - 50mm FIBRE fon MICRO SLAB 50
  - 100mm (min) mineral wool insulation (45kg/m<sup>3</sup>) between joists
- Ceiling** See Table TF11b for ceiling treatment



**FASTRACKCAD**  
ARCHITECTURAL CAD DATABASES

Fig. TF11b

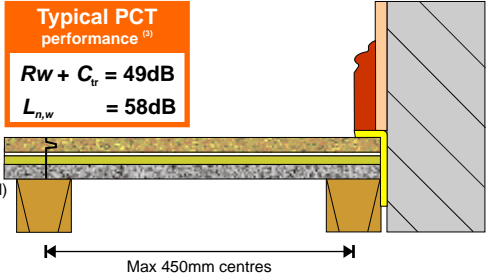
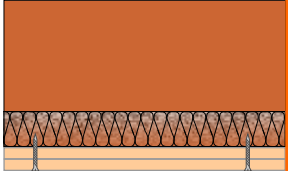
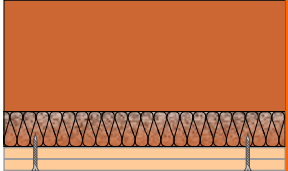
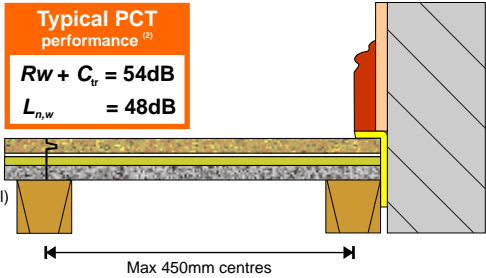
Table TF11b

PCT floating floor treatment	Perimeter resilient flanking strip required	Ceiling treatment options
<p><b>DECKfon Quattro</b> <span style="border: 1px solid green; border-radius: 50%; padding: 2px;">0 GWP</span> Composite acoustic structural overlay board</p> <p><b>Typical PCT performance</b><sup>(1)</sup> <math>R_w + C_{tr} = 49\text{dB}</math> <math>L_{n,w} = 58\text{dB}</math></p> <p><b>Product information</b> Board dimensions: 45mm (t) x 600mm (w) x 2400mm (l) Edge profile: Tongue &amp; groove Weight: 20.00kg/m<sup>2</sup> / 28.88kg per board</p> 	<p><b>YELOfon ES5/120</b></p> <p>Polyethylene foam flanking strip: 5mm (t) x 120mm (h) x 50m (l) placed around the perimeter of the flooring board to isolate floor from walls and skirting.</p> 	<p><b>Ceiling treatment</b> Gypsum-based plasterboard ceiling with minimum mass of 16kg/m<sup>2</sup>, fixed directly to floorjoists.</p> 
<p><b>DECKfon Quattro</b> <span style="border: 1px solid green; border-radius: 50%; padding: 2px;">0 GWP</span> Composite acoustic structural overlay board</p> <p><b>Typical PCT performance</b><sup>(2)</sup> <math>R_w + C_{tr} = 54\text{dB}</math> <math>L_{n,w} = 48\text{dB}</math></p> <p><b>Product information</b> Board dimensions: 45mm (t) x 600mm (w) x 2400mm (l) Edge profile: Tongue &amp; groove Weight: 20.00kg/m<sup>2</sup> / 28.88kg per board</p>  <p><b>Construction notes</b> Materials must be installed in accordance with manufacturers' instructions to achieve stated acoustic values. Wall treatments <b>MUST</b> be isolated from the floating floor with YELOfon ES5/120 flanking strip. Ensure services do not come into contact with the floor treatment. Services must not puncture ceiling linings (except cables, which should be sealed with flexible sealant).</p>	<p><b>YELOfon ES5/120</b></p> <p>Polyethylene foam flanking strip: 5mm (t) x 120mm (h) x 50m (l) placed around the perimeter of the flooring board to isolate floor from walls and skirting.</p> 	

**Acoustic values**

<sup>(1)</sup> Test data quoted was conducted in a UKAS accredited laboratory in accordance with Approved Document E: Annex B: Procedures for sound insulation testing. Airborne results tested in accordance with BS EN ISO 140-3:1995 Impact results tested in accordance with BS EN ISO 140-6: 1998