

Structural separating floor - Timber (existing)

PCT solution

Existing timber joists
Acoustic treatment laid directly on floor joists

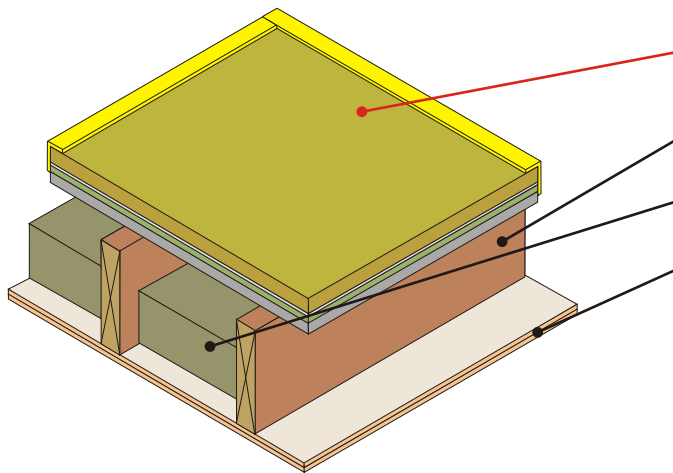

| | |
|--|---|
| Structural floating floor treatment | DECKfon Quattro (See Table. 12 for full details) |
| Joists | Solid timber joists |
| Absorbing material | 100mm (min) mineral wool insulation (45kg/m ³) between joists |
| Ceiling | See Table.12 for ceiling treatments |

Fig. 12

Table. 12

| PCT floating floor treatment | Perimeter resilient flanking strip required | Ceiling treatment and void insulation |
|--|--|---|
| <p>DECKfon Quattro Composite acoustic structural overlay board</p> <p>Typical PCT performance values: $R_w + C_{tr} = 49\text{dB}$ $L_{n,w} = 58\text{dB}$</p> <p>Product information Board dimensions: 45mm (t) x 600mm (w) x 2400mm (l) Edge profile: Tongue and groove Weight: 20.00kg/m² / 28.00kg per board</p> <p>Construction notes. Materials must be installed in accordance with manufacturers' instructions to achieve stated acoustic values. Deckfon Quattro structural overlay system laid in a staggered formation with all joints using a suitable adhesive on 50mm x 235mm solid timber joists set at 450mm centres, 100mm 45kg/m³ mineral wool slab fitted in between and 2 layers of 12mm (8kg/m²) plasterboard fixed direct to the floor joists. Wall treatments MUST be isolated from the floating floor with YELOfon ES5/120 perimeter flanking strip.</p> | <p>YELOfon ES5/120</p> <p>Polyethylene foam flanking strip - 5mm (t) x 120mm (h) x 50m (l) placed around the perimeter of the flooring board to isolate floor from walls and skirting</p> | <p>Ceiling treatment Gypsum-based plasterboard ceiling with minimum mass of 16kg/m², fixed direct to floor joists.</p> |
| <p>DECKfon Quattro Composite acoustic structural overlay board</p> <p>Typical PCT performance values: $R_w + C_{tr} = 54\text{dB}$ $L_{n,w} = 48\text{dB}$</p> <p>Product information Board dimensions: 45mm (t) x 600mm (w) x 2400mm (l) Edge profile: Tongue and groove Weight: 20.00kg/m² / 28.00kg per board</p> <p>Construction notes. Materials must be installed in accordance with manufacturers' instructions to achieve stated acoustic values. Deckfon Quattro structural overlay system laid in a staggered formation with all joints using a suitable adhesive on 50mm x 235mm solid timber joists set at 450mm centres, with 100mm 45kg/m³ mineral wool slab fitted in between and 2 layers of 15mm (12.5kg/m²) plasterboard on resilient bars perpendicular to the joists fixed at 400mm centres. Wall treatments MUST be isolated from the floating floor with YELOfon ES5/120 perimeter flanking strip.</p> | <p>YELOfon ES5/120</p> <p>Polyethylene foam flanking strip - 5mm (t) x 120mm (h) x 50m (l) placed around the perimeter of the flooring board to isolate floor from walls and skirting</p> | <p>Ceiling treatment Two layers of gypsum-based board, composed of 15mm (nominal 12.5kg/m²) fixed with 25mm screws and a second layer of 15mm (nominal 12.5kg/m²) fixed with 42mm screws, with all joists staggered.</p> |

Acoustic values.
Test data quoted has been conducted at Sound Research Laboratories, Sudbury, UKAS ref. 0444. Airborne results tested in accordance with BS EN ISO 140-3: 1995 and rated in accordance with BS ISO 717-1: 1997. Impact results tested in accordance with BS EN ISO 140-6: 1998 and rated in accordance with BS ISO 717-2: 1997.